



Patrick MacManaway

President's Address

This New Year sees us smoothly and safely transitioned into our new premises in Malvern, with the day to day management of the Society's affairs being taken care of by Ian Clements, Jenny Davies and Helen Lamb. Our London lectures have also changed their venue, with meetings now being held at the Friend's Meeting House in Euston. The process of internal review and transition is also afoot, although rather less visibly, with some restructuring of the organisational aspects of the Society, bringing greater advantage, ease and efficiency to the workings and co-ordination of the many and various activities that our Society houses and supports.

Throughout this transitional period however, I am confident that the Spirit of the Society is remaining stable and continuing to grow in strength and clarity, and that the end result of this process will be one of sustained and vibrant health and growth, and that the activities of dowsers will be increasingly well supported, represented, and presented in a contemporary and continuingly relevant fashion.

Winter generally brings our attention closer to home as the season contracts and compresses, and I have found my dowsing leading me in the same direction, with renewed attention to dowsing for personal health and also consulting with the pendulum on both business and personal projects and goals as the new year stretches out ahead as empty

pages in my diary and events planner.

If you too are helping yourself to maintain good health and energy with your dowsing at this time of year, I recommend that when checking nutritional and other basic needs that may need seasonal attention or adjustment, that you also check for your state of hydration and whether or not an increased water intake is required. It seems greatly paradoxical that dehydration should be a winter concern, but the air quality in many of our homes and places of work becomes very dry when being constantly heated, and feeling cold can suppress our thirst. Many of the season's respiratory illnesses can be traced to mild personal dehydration, with dowsing in classic fashion indicating what may not at first be apparent to our other senses, yet bringing us to simple, straightforward and practical results. Simple, straightforward and practical – I continue to hear Past-President Major General Bill Cooper's often repeated words "keep it simple" and pass them on again as one of the sagest pieces of dowsing advice to come to me.

We look forward to a very active year of courses and activities being organised by the Special Interest and local dowsing groups, and are currently engaged in planning a somewhat redesigned conference programme which we hope you will be excited to attend and participate in.

I hope to see many of you at events as the year unfolds and meanwhile wish you the very best of dowsing



Patrick Leonard

Early Church Sites

WHY THOSE EARLY CHURCHES WERE PLACED WHERE THEY ARE

This article is aimed primarily at the Dowser, but it may open the eyes of others.

This is a gleaning of understanding of mankind's evolution as a society. It is simply a synopsis of events, in general through time, as I just want to show a series of important events, during mankind's evolution. 60 years ago when I was at school, history was about the last 2,000 years. Prior to that mankind was considered to be made up of ignorant savages, who covered themselves in a dye called Woad, battled with neighbouring tribes, and were generally considered to be illiterate. At least, that was the general perception of the people of this country.

During the past 60 years, great strides have been made in the understanding of this country's inhabitants, and much of our earlier history has now been re-written, thanks to Archaeologists and modern Historians. For instance, archaeologists have found field enclosures in the area of Peterborough, with dug Wells, that date back to 12,000 B.C. This tells us that at that period, some people at least had certainly turned away from a total life of "Hunter gatherer", and remained in one place. Whether the fields were for crops, or domesticated animals, is not known. A Professor of Leicester University, has made a long study of the Jurassic Way, which is an early road running from Lincolnshire in the North to Devon in the South. This follows the natural Jurassic

clays, so people must have used that clay for some reason. The Professor dated this road at about 10,000 B.C., he stated that in places it was "Dual carriageway", and each carriageway was approximately 30ft wide. (Two way "traffic" – the mind boggles.) Why two carriageways side by side? In places, he also found traces of ditches. These are not the actions of ignorant savages. I tell you these snippets of history, to demonstrate how our understanding of early history has improved over the years. In "their" way, the people of those early times, had a knowledge and understanding that we today no longer possess as a society. The communities then were much more "in tune" with what went on around them, together with a knowledge of the Earth itself. They were as clever, in their way, as we are in ours. This leads me on to what we would call:–

THE PAGAN PERIOD

Nobody really knows when this period started. It was probably because of a certain mindset in the way of thinking about things, and the thirst for more knowledge, that a "common consensus" permeated the society of the day, of how things fitted together in Nature. Some historians think that by 8,000 B.C. this consensus had quite a sizeable foothold in the society of the day. However, even by 5,000 B.C. they were already leaving evidence that is now coming to light. Whether this way of understanding evolved here, or whether it came across from the continent,

Early Church Sites

nobody knows. Whatever, a type of "Civilisation" of that period gradually built up. A civilisation, the knowledge of which, we are only now beginning to scratch the surface of. But remember, there have been many civilisations throughout the world, and none have stood the test of time. All gradually declined for one reason or another. Many people in our society, consider that the Pagan way of life was a Religion. In common with many others, I do not. It was more a way of understanding, that helped them simply to live life and prosper in harmony with nature. Around that 5,000 B.C. period they had a certain knowledge of the skies. They



**Church Cove, The Lizard,
Cornwall**

obviously wanted to learn more. By this period the population in general was stable to the point of farming rather than hunter gathering. Their knowledge of all things around was increasing, and as well as a good spoken language, they also had developed an understanding of mathematics. Measurements of many things are essential in a stable society. I will give you a for instance. In Persia, (now Iran) in 12,000 B.C. they constructed underground tunnels in stone in cut blocks of regular sizes. These tunnels carried water to dry regions for up to twenty miles from the source, and from start to finish they had a fine enough gradient to enable the water to run all the way using gravity alone. Dotted along these tunnels were wells, sunk so that local inhabitants could draw water. They had a stable population at that period, and there was no way they could have completed these feats of engineering, without a knowledge of some sort of Mathematics.

And so to our Pagan ancestors. They realised that what they needed was a permanent fixture on the ground that they could reference their observations to. From this fixed point they could measure movement at any time of the year. They could also measure angles, between one observed object and another. Any deviation noted would tell them that one moved at a different rate to the other. It would be a subject on its own to write about the enormous amounts of new knowledge that were to be gleaned during these times. What I am more interested in at this stage is to explain to you what were the fundamental requirements that they set themselves in the construction of these early Observatories. Having spent some 35 years studying literally dozens of these sites I can now see what these basic requirements were. Bear in mind that our ancestors knew their surroundings in a way that we as a society have now forgotten. Their first requirement was:-

NATURAL MAJOR EARTH ENERGIES

They required a position that had two kinds of natural Energy. ALL of the sites I have studied have these. The first is a concentration of underground water in quite large quantities. It also had to be very good water. The energy this water gave off was used in a way that, as yet, nobody fully understands. The second energy was and is one that flows over the surface of the land. A site where two or more of these energies converged, or crossed over each other, was essential. The more there was of these two energies at a given site, it would seem the more powerful the site was, but of course we don't know fully its use. The over ground type of energy that can run for, in some cases, many miles, it is

commonly called Ley Lines. However, I would like to correct the terminology here very strongly. The two words of Ley and Line tell us NOTHING AT ALL. Firstly, the word Ley according to The Oxford English Dictionary, is a straight line between at least three ancient sites. The word line, again in the O.E.D. is anything that goes in a continuous line. So both of those two words are saying LINE – LINE. It does not convey information in any descriptive way. (Where would we be if our Botanists described plants in that way?) What our ancestors sought, and what we still have at those sites are, Major energy, and you can add Leys on to the end if you wish. These three words do at least give us a basic description of this type of energy. These are the natural Major Energies that the planet produces. The planet also produces many lesser energies as well, so this should be born in mind when Dowsing any energies. What I have found over these many years is that these Major Energies start and finish at water, often a Spring, or a Pond fed by a spring. These are the overground runs of the underground water. These springs where the water leaks out on the surface, also leak out its underground energy. While on this subject, I will add a theory which has been evolving in my mind, but as yet I have NO PROOF for it. From my "learnings" many things point in the direction of "Healing" for the use of these Major Energies, and healing by immersing the person in water at the sites where these energies emanate from the ground. We have a Biblical clue which is a couple of thousand years old. That is of John The Baptist, who immersed people fully in water. Many religions of today still do the same. It is these clues from the past, as well as others that have pointed my thinking in that way.

I have digressed somewhat, so I will get back on track. The next thing our ancestors needed in their study of the skies and construction of their Observatories was:-

LARGE VIEWABLE SKIES

To this end they sought a position which had the previous factors but was on Low ground with quite distant horizons or was in a low part of a wide valley. Either way, they had large skies to view, and horizons to reference to. If these three factors fitted, then construction was started. The first item they constructed was a:-

MOUND

A Mound was a static point, on the ground. These mounds were often quite large. One I measured was 600ft in diameter, and 60ft in height. But these mounds varied in size. All, however, were conical in shape. They were all constructed using the local soil, as this was an easily movable medium and was malleable to whatever size was required. From these mounds they laid down alignments, which were measured off areas of land. The first it would appear was due South. Firstly, because, their most important area of viewed sky was the Southern sky. Also, when the Sun sat at the far end of this alignment they could calculate the Mid Day, as this would vary according to the time of year. I will not go into all the various alignments here, as it is yet another subject on its own, but take a look around your village and see how many streets align North to South, and East to West.

There was a final item which our ancestors used, which was:-

Early Church Sites

SURFACE WATER

Where possible, they flooded an area of land, or constructed a Pond, as large as was possible. In either case, it had to be an area of very still water, the reason being that these areas of still water were used for observing the sky in reflection. Observing in reflection has the advantage that it cuts out a lot of the background light of the stars, so items being observed could be seen clearer. Moving objects could be measured with a greater accuracy. It is interesting to note that in Japan, a special observatory was constructed some years ago to observe in this way, but has also the added advantage of optical instruments. Silbury Hill, near Stonehenge, is a classic example of a viewing mound, part



Ash Church

surrounded by a flooded wide ditch which would have been used for viewing in reflection, the mound never having been disturbed by Religion. There are many church sites that have water near. A good example is Earls Barton in Northamptonshire. The North side original viewing ditch was still flooded until the 1930s when the West end was dug out and the ditch kept drained. I can only assume that all our ancestors had was two good eyes. The location of these surface areas of water

varies. The majority of these ancient sites seem to favour the South side of the complex. But some are on the North side, so I suppose the observers of the day, at that point, must have concentrated on the Northern sky. But, no doubt, information was swapped with other people on other sites.

By now, you are wondering what this idiot is babbling on about. Paganism, Observatories, Energies, Water. What does it have to do with EARLY CHURCH SITES. Patience, dear reader, all will be revealed. You need to know the background and chronology of events, to get a better understanding, of where we are heading.

PRECESSION

It is my belief, that this was the major cause of the decline of the greatest part of the Pagan way of life. I will explain, as briefly as I can, what Precession is.

As you know, the Earth turns on its Axis once a day. That Axis "wobbles" as the Earth is spinning. It continually wobbles out of centre, and takes 26,000 years to wobble around in a full circle, so the wobble is quite slow. Modern astronomers of course know all about this, and can adjust their calculations accordingly. Our ancestors no doubt had no knowledge of it. Therefore, their "Static" points and layouts on the ground, became "inaccurate" after a few centuries. Initially, as the Precession is very slow, then the adjustments to these static points was relatively easy. As thousands of years went by, the adjustments were too great, and their knowledge too inaccurate for it all to continue. So, new thinking had to be applied. It is my belief that this is the period when Stone Circles came into being. A totally different layout on the ground to study the skies. Unfortunately, these too, suffered the same fate with time. By this period, some time after about 1,500 B.C., the way of life of our ancestors took on a much briefer existence. We could liken it to "The Dark Ages". It was their Dark Age. Their civilisation went into a decline, and probably for many other reasons as well. What they appeared to do was:-

RETURN TO THE EARLY LAYOUTS

These early layouts were still revered probably because of the Energies at those points, maybe – just maybe – for the Healing that could be given there. But those alignments on the ground now became paths and roads. People built their dwellings either side of these. They became villages, and that early built mound became the focal point for all in that particular area. And so life carried on more or less in this way, despite the many comings and goings of other incoming peoples, and all their troubles to the local way of life. It really was in general a Dark Age as so little is known about this period in time. Even when:-

THE ROMANS CAME

Little changed for the general population. They still went on with their farming, living in their villages, building and rebuilding their places of habitation along both sides of these early observatory layouts. In many ways we can liken it to what is happening in Iraq today. The Romans gradually suppressed the larger conurbations, but left the people of the countryside alone to get on with their lives so long as they didn't give trouble. Although by this period this country had split up into many kingdoms, that basic village existence still carried on, the people still practiced their Pagan ways.

In 313 A.D. the ruling Roman Emperor, Constantine, who by then had become a "Christian", gave a decree that all lands and Protectorates that Rome controlled should embrace the Christian faith. Very, very gradually it began to permeate into this country's population. Many areas resisted very strongly, as they wished to continue in their Pagan way, which their ancestors had observed for a long, long time. Human thinking is always set to resist change. But, within a century, the Romans began leaving this country after a 400 year rule.

Christianity continued to struggle in getting a foothold. Where it did, it didn't give the people a totally new way of life, but knitted itself into the everyday life of the people. So, what better place could there be to try and convert the people into this new thinking, but go to their "Special" places. These special places were their village Mounds. It gave the "locals" a continuity from one way of thinking to another. Things slowly ticked along for many more centuries, the country became controlled by others. The Angles, the Saxons, the Danes, The Jutes, the biggest change taking place with the:-

SAXON RULE

The Saxons brought much greater stability to the population after the many generations of trouble after the Romans left. They also spread Christianity in a greater way than before. Again it was knitted in to the still practiced Pagan way. And again, in the village communities, it was taken to those important Mounds. Early Saxon churches were wooden built and placed on the top of these still existing mounds. What were originally built as observing points, and had stood the test of time in their use, had now become Christian religious sites. In a few areas the Saxons did build in stone. They built Cathedrals for the governing of areas of religion. In some instances, they built fortified towers, for the use of the local Saxon rulers. These towers were also built on the mounds, as it gave them a high vantage point. It was also the point where their enemies

Early Church Sites

could find them on a regular basis whenever they went to worship! We have very fine Saxon towers still standing in my county of Northamptonshire. Firstly, at the village of Earls Barton stands a square tower and at Brixworth is a round tower. Both are now attached to the church but originally would have stood alone. Brixworth in the 6th century became the Religious ruling point for this area. General life plodded along for many centuries until:-

1066 AND ALL THAT

I am pretty sure that the majority of people reading this will know that 1066 A.D. was when this country was conquered by the Norman French. Life here then took a very big change. We still had villages, where they had always been, now for thousands of years. The general population were still farming. A large amount of the population had become christianised. The Normans initially put the rule of the population under a single King. William. They organised the country, and put their own Barons in charge of nominated areas, these being answerable to the King. As they were Christian in their belief, in less than 200 years from taking over, they put into place a large church building programme.

The Normans were great builders in stone. All villages of adequate size had to have a church. Where Saxon towers still existed, most were pulled down and the stone was used in the construction of the church.

And where did they place the churches? But of course, you guessed, didn't you? ON TOP OF THE MOUND.

What they did was to remove sufficient soil from the top so it gave a flat area large enough to fit the proposed building on. But, and I will say But again, the constructors of these churches still retained some Pagan ways in their thinking and incorporated them in the construction. Firstly, they placed the building so that the greatest concentration of those MAJOR ENERGY LEYS, and ENERGY FROM UNDERGROUND WATER, were to be found inside the walls of the building. Secondly, you will find churches align, more or less, East to West with the Chancel at the East end. Why?

Were you ever told why? If so, what were you told? If not, have you ever wondered why, or has it never crossed your mind? Or, have you never even noticed? Well, I will explain as much as I have learned which seems to fit the bill. To the Pagan thinking, the Sun was the all important object in the sky. It was considered to be the "engine", which drove, if I can put it that way, everything here on the Earth. At the end of each year, when the Sun rose and set at its farthest point South,

they held a very Major Festival, which was the Festival of The Unconquered Sun. The Sun had gone through a full year's cycle, unconquered by anything. This is where they gave thanks for another full year. The next important Festival was at the Half Year. This was the time when sunrise was more or less due East. It was a time when the bounty of the earth could be harvested, or just prior to harvest. Of all their festivals this was the most important one. If the Sun had been kind to the earth, and the earth had been kind to them, then they were rewarded with all types of crops that would sustain them until the next harvest time. Therefore, early churches were aligned to approximately this Mid-summer sunrise. And the most important end of the building was placed at that East end.

If you take a Compass with you when you visit any churches, and take note of the bearing of that East to West alignment, you will find variations from one church to another. The reason being that the builders of each church building aligned it with the known Mid-summer day for that position. What dictated that was the horizon in that direction.

CONCLUSION

What I have been able to show you here is a very, brief history of events, that has culminated in the placing of the "Early Church Sites" in this country of ours. In my own County of Northamptonshire we have about 300 churches placed on the remains of those early observatory mounds. Not all were used in this way, as there are many to be found with no churches on them and no villages around them. But with that ability to Dowse, it was easy enough to check which started out life as an observatory mound, and which didn't. So, dear reader, Dowse your local church. Establish its Energies, if it has them. Look at the surrounding village, see how many streets, roads, footpaths, align North to South, or East to West, or any other common variation that you can find in other villages. Does the village still have a village Pond? Or, is there a Spring or Stream that could have been used to flood an area of land, that gave still water for observing in reflection? Water of some sort is usually not too far away with regards to these "higher" graveyards and church sites. It was thought for a very long time that the ground gradually got raised up with the many burials over the many centuries, but now you know different. How many of these sites can you find in your area? You have all the information here to check them out. As a Dowser you have a greater advantage than most as you can find what can't be seen. Use your dowsing skills. Happy history hunting.

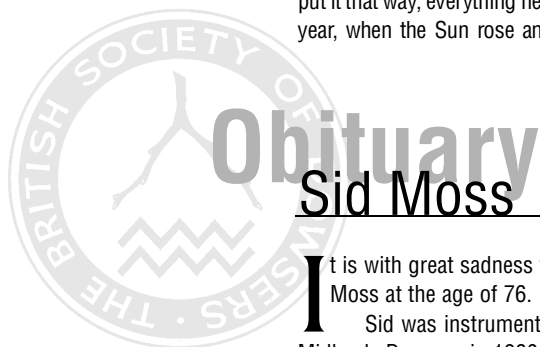

Sid Moss

It is with great sadness that I report the death of Sidney Moss at the age of 76.

Sid was instrumental in the formation of The West Midlands Dowsters in 1980 and remained a loyal supporter, despite less than perfect health for the rest of his life.

Sid's particular forte, apart from finding many interesting dowsing sites for exploration by group members, was in the reproduction of dowsing instruments of all types gleaned from information buried in books and

papers from the past. He used his extensive skills as a design engineer to produce an astonishing range of dowsing tools employed over the years, but his masterpiece was the gimbal mounted pendulum, crafted from his own design, which drew much admiration from all that saw it.

We mourn the loss of an old friend and send our sincere condolences to Sids wife Joan.

Micheal Guest



Richard Moore

Water Divining

It's an appropriately damp, dank morning in Dollar for a meeting with a water diviner. A burn runs down the middle of the street – today it is in full flow. And out in the road stands an elderly gentleman; tall, with a shock of white hair, tweed plus-fours, socks, flashes, shirt, tie, green bodywarmer and, in an incongruous but characteristically eccentric touch, brand spanking new trainers. The car rolls to a halt outside beside a sign saying 'Water Diviner' and at the feet of the water diviner himself. He offers a friendly greeting in a cut glass accent: "Come on old boy. Stick her in the drive and step this way, into the bachelor's quarters."

Michael Cranfield is one of Scotland's only water diviners, or, to use the preferred term of the practitioner, water dowsers. At eighty, he is the most senior in experience and reputation, and he is much in demand.

From championship golf courses to farms, Knockhill motor racing circuit to Edinburgh Zoo, Cranfield has picked up his divining rods with a firm hand and gone to work, treading slowly across the land, his eyes closed and brow furrowed in intense concentration. When there's water, even as deep as 450ft beneath the surface, the rod appears to take on a life of its own, forging upwards with Cranfield apparently struggling just to hold on to it. The force is such, he says, that if you try to hold it back then his trusty hazel twig can snap in two.

How it works, he's not entirely sure. No one is. But a 94.6% success rate does suggest that Cranfield is blessed with whatever gift it is that that possesses the water diviner. Even the British Society of Dowsers – whose magazine, *Dowsing Today*, must feature as a guest publication on *Have I Got News For You* – concedes that it's a bit of a mystery. "There is no universally accepted basis of explanation for dowsing phenomena," admits the BSD. "Practising dowsers appear to dislike systematic theorising, and to prefer narrative descriptions of their own experiences and interpretations."

"I'm just a dull old chap who finds water," says Cranfield, pointing out that gold and oil and other underground materials, can be divined. As the Society says, dowsing can be defined as "the art of practice of discovering substances, objects or persons, missing or not apparent to the senses, by using rods, pendulums and similar simple aids." The first recorded use of the term 'dowser' was by John Locke in 1692.

Cranfield first divined water in 1936, but it is only in retirement that a career in this field has really taken off, and this second chapter of his life reads like something from the imagination of Alexander McCall Smith. Like McCall Smith's Precious Ramotswe, proprietor of the No.1 Ladies' Detective Agency, Cranfield provides an unconventional but effective service, as well as one that owes something to the realms of the paranormal. Like Mma Ramotswe, Cranfield, the proprietor of Scotland's No.1 Water Divining Agency, does not seem quite of this world, or this time. And it's not just because the grandfather clock in the aforementioned bachelor's quarters is stuck at 6.45.

When he was 18 Cranfield began serving as a World War Two bomber pilot. "The sky over Germany in war time is a very lonely place," he attests. "Eighteen, nineteen is a very impressionable age. Your memories of that time stay with you all your life. I can remember it as if it was

yesterday." He hoots with laughter as he adds: "Yet I can't remember what I was doing yesterday." After the War he entered the food industry, working first in London then in Scotland. He has lived in Scotland for 40 years, raising his family here. His wife, Sheila, died five years ago.

The seed of this second career was sown some 67 years ago, when a Commander Low, from HMS York, came to stay with Cranfield's family. "Commander Low had been in Ceylon, where they were building a runway," says Cranfield. "It was sagging in the middle and Commander Low, with his water divining skills, was able to tell them why: there was water beneath the surface!"

"My brother was eight at the time, I was 13, and we were inquisitive. We asked, 'How do you do that?' So he went outside, cut a twig from the hedge, went over my father's lawn, and up went the stick. I tried it and it happened naturally to me. A lot of people have the latent ability, but not everyone. My brother didn't have it."

"It's a funny thing," he continues. "I've got five children and my eldest son, Landale, has the knack, the others don't. He's a deep sea driller, and he works all around the world, but he's done quite a lot of divining."

The way Cranfield describes it, the ability to divine water cannot be learned, and nor does it disappear. As he approached retirement he began taking his divining rods – actually fork-shaped hazel twigs – to game fairs and agricultural shows.

"People were very interested, especially farmers, who could see that I could save them a lot of money in water bills if they could discover underground sources of water," he says. "There was a need for someone with the skills I had and I started doing this professionally, so to speak. I put a wee advert in *Scottish Farmer* magazine and I went to the Royal Highland Show. In two days there I got enough work for a year. There was nobody else doing it, that was the thing."

In the last decade Cranfield has discovered water in more than 800 sites. The saving to his clients can be counted in thousands, possibly even millions. When Paul Lawrie won the Open at Carnoustie in 1999 he could thank Cranfield for the quality of the greens. A year earlier, he had discovered water running deep beneath the surface. They needed 720,000 gallons a day; Cranfield delivered. A letter from the management committee addresses him "Master Water Diviner Extraordinaire." A headline in the magazine *Greenkeeper International* described him as "Britain's most wanted man."

What is truly extraordinary, however, is Cranfield's ability to discover water using only a map and a pendulum. Holding the pendulum above the map, he finds that it begins to rotate when it hovers above a source of water. It is as baffling as it sounds.

"My son introduced me to map dowsing," Cranfield says. "Divining is absolutely draining and he was worried I was tiring myself out. Of course I didn't think it was possible. But I read about it and practised it and it's astonishing. I can't explain it, but it's very practical because I'm not as physically active as I used to be. Now I always use a map before I visit a site. Sometimes I don't even visit the site. Using a map I've discovered water on an island in British Columbia.

Water Divining

"I can understand why the rods might work. If you remember your physics, then you'll know that movement means energy. The earth is a moving thing, and therefore is sending energy, and somehow or other when that energy passes through water I can pick it up. It is incredible and it's something I love doing. It's like painting – you're in a trance; completely in another world."

Others, and not just cynics, are just as baffled by Cranfield's success rate. When he started out, he asked previous clients for written proof of his success, "because no one would bloody believe me!"

Now he produces a file, bulging with references. "I personally accompanied Mr Cranfield on the three occasions he visited the golf courses," says a club chairman. "Whilst I found his desk study method of determining in which location to divine rather unorthodox,

water was found in subsequent test bores at the very points where he indicated using his divining rod. I am more than happy to recommend him to those persons or organisations who require the services of a reputable water diviner."

Another testimonial reads: "It is a most unusual gift he has and because his charges are so reasonable I recommend anyone to make use of his services." Yet another says: "To be quite honest I did not really believe in water diviners, but rather than drill haphazardly I decided that it must be a little better to try this method. Napoleon is supposed to have said that if you do something right one time it may be luck, but if you are successful several times then you are talented."

"We send our thanks and our best wishes," says another, "to you and your hazel rods."

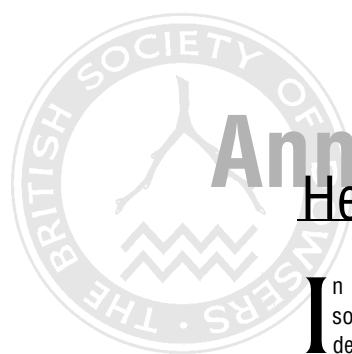

Ann and Roy Procter Healing Sick Houses – Part 2

In the September edition of *Dowsing Today*, we gave some background to our work healing sick houses and details of our research project. In this, the second part of our paper, we offer more about the sample, i.e. the people who participated in the project; how we excluded the placebo effect; something about sorting out the data, and announce our results.

THE SAMPLE

The sample for this research was drawn directly from 105 households which requested dowsing and healing work for problems which they believed to be associated with negative earth energies or discarnate presences. This is not a random population sample. It is a sample selected by application and is selected on the basis of households who, in the first instance, are experiencing some sort of difficulty, most usually ill health. Secondly, they believe in the possibility that the effects of negative earth energies might be contributing to their difficulties, and thirdly believe in the possibility of ameliorating the effects of these negative earth energies through dowsing and healing. Given the high response rate, and the apparent similarity between those who did and those who did not complete all the questionnaires, we can be confident that respondents are broadly representative of inquiring households.

The reasons for requesting dowsing and healing are various, as are the methods by which households were referred for assistance. The main means of referral was through reputation and 'word of mouth'. Most enquiries (90%) were the result of referrals by friends or therapists who had direct experience or knowledge of dowsing and healing in relation to the effects of negative earth energies. The other significant route was through various articles written and talks given by us over the years. As a result, our work has snowballed as satisfied clients told others about our work and passed on our information leaflet. An

article in the Sunday Times (March 1998) overwhelmed us with 800 enquiries, many of them wanting work done immediately!

All respondents described adverse personal symptoms while only 48 respondents were able to describe any symptoms specifically related to the house, for example cold damp rooms, unexplained noises etc. Over 40% indicated a formal medical diagnosis for their personal symptoms with cancer, ME and chronic fatigue figuring strongly among the physical diagnoses and depression among the mental diagnoses. Emotional and "psychic" symptoms were less commonly reported.

The symptoms reported by respondents were broken down into four main groups as follows:-

| | |
|---------------|----|
| Physical | 88 |
| Psychological | 74 |
| Emotional | 35 |
| "Psychic" | 37 |

Over three quarters of respondents had received, and in some cases continued to receive, other forms of treatment for their personal symptoms. Although alternative and complementary treatments were the most widely used (by 55% of the respondents), the difference was not that great. Orthodox medical treatments were used by 41% of respondents.

RESPONSE RATE

Self-completion postal questionnaire surveys attract notoriously low response rates; all the more so where the respondents are required to complete four questionnaires over a period of time. The accuracy and reliability of survey data are undermined by attrition or non-response because, in general, non-respondents differ from those who do respond and in ways which are unknown and which therefore cannot be controlled. Where non-response is large, the resulting level of bias is unacceptable and the

Healing Sick Houses – Part 2

findings of the survey cannot be generalised beyond those achieved for the respondents.

150 respondents were each asked to complete 4 questionnaires over a period of about 2 months. Thus there were potentially a total of 600 questionnaires to be returned, and each respondent had four opportunities to opt out.

The actual number of questionnaires returned was:-

- Questionnaire 1) 129 (86%)
- Questionnaire 2) 119 (79%)
- Questionnaire 3) 110 (73%)
- Questionnaire 4) 105 (70%)

Our statistical expert described the response rate as remarkable, substantially better than most other surveys of this type. One reason for this is that, through their application for treatment, respondents self-select themselves into the sample by reason of their sympathy with, and confidence in, dowsing and healing as a treatment for their symptoms. Nevertheless, we felt very gratified that so many people had taken the trouble to fill in their questionnaires and return them as requested.

SORTING OUT THE DATA

How then did respondents evaluate their general health and wellbeing prior to treatment? At the outset each respondent was asked to rate their overall health and wellbeing according to the following categories: 'very good', 'good', 'fair', 'poor' and 'very poor'. In addition, each respondent was asked to provide more detailed information about their health and wellbeing in the form of scoring the intensity and frequency with which they experienced 26 specific health and house related conditions. The test of

effectiveness of the healing is based upon a statistical comparison of responses before and after healing. This was the chief purpose of this investigation and is completed for the sample for the general health question and for each of the 26 questions which relate to specific symptoms. The intensity and frequency with which the reported symptoms occur are recorded separately. The timing of any improvement

over a period of eight weeks from the intervention is also able to be assessed. These are aggregate analyses in that they provide an overall indication of the effectiveness of the healing across the whole sample. It may be that the healing is more effective at treating particular sources of negative energy or at treating specific symptoms. From the detailed information collected about the sample, respondents can be categorised according to household characteristics and diagnosed problems and any patterns of differential effectiveness in treatment investigated. The analysis of all this data belongs to the expertise of Dr Vicky Wass, and is largely beyond our comprehension.

THE PLACEBO EFFECT

A vital consideration when designing a project of this kind is the placebo effect. A placebo response is one which is generated from an inactive intervention. In medical trials it might be achieved by giving a dummy pill to a control group. It is not the same as no treatment. Placebo responses are observed to be a powerful and widespread phenomena. They are normally explained as the fulfilment of an expectation of a beneficial effect of the treatment on the part of the patient. The therapist believes in the power of the treatment and communicates this to the patient who thus learns to expect a successful outcome. Placebo effects are an empirical fact of life. In the medical literature they are treated as an error of observation to be eradicated from the data in order to achieve a 'true' measure of the effect of the treatment. A great deal of emphasis is placed upon achieving net outcomes after the removal of any placebo effects. A treatment is effective only to the extent that it achieves a positive net outcome, that is an outcome which is superior to that of a placebo.

The potential for a positive placebo response in the healing we are doing is considerable. Application for treatment is self-selected and highly motivated. If not in general severe, the adverse symptoms experienced by applicants are often of an intractable nature and had proved immune to other treatments. Application for treatment often involved, in the first instance, a telephone conversation with one of us where acceptance, sympathy and comfort were offered (provided the moment was not TOO inconvenient!). Good intention engenders hope and, if expectation grows with hope, then applicants would have had high expectations that the treatment would be successful. Our interest is largely directed towards gross outcomes, that is an improvement in health, rather than in whether this was a 'true' or a placebo response. However, for reasons of convention, curiosity and the considerable potential for a placebo effect, the survey was designed to incorporate a test for placebo effects.

At Questionnaire 2, respondents were randomly allocated to an experimental group where the dowsing and healing had been done and a separate control group where it had not until later. The allocation was double blind in that neither the respondent nor the researcher knew whether the work had been done. A comparison of outcomes across the experimental and control groups provides a measure of the placebo response. So the survey design was based upon the classic method: the pre-healing responses at the second questionnaire stage comprised the control group, and the post-healing responses comprised the experimental group, and the test of effectiveness comprised the comparison of results between the two groups. Unlike the traditional control group, respondents were themselves used as their own control group. The reason for this is a simple one. It would have been inappropriate to withhold a potentially beneficial treatment from certain households in order to provide a control group, most especially since those households had specifically requested that they receive the treatment.

THE RESULTS

These are shown in Figure 4. At questionnaire four stage, a month or more after healing, 85 of the 105

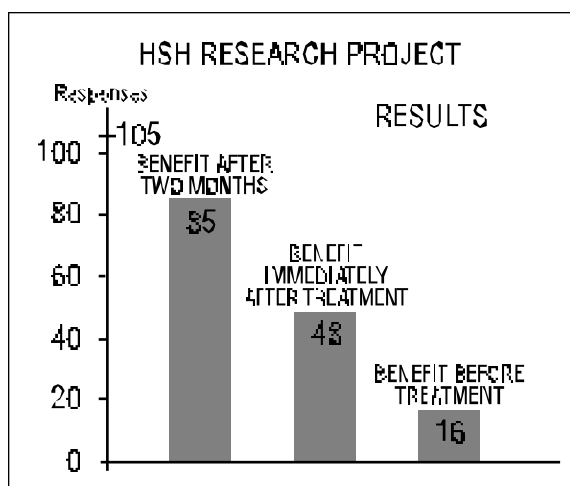

Fig. 4

Healing Sick Houses – Part 2

respondents showed, by their filling of the questionnaires, that they experienced some improvement in health. “*This is a pleasingly high number!*” quoth our statistical expert! At the Questionnaire 2 stage, within a week of healing, 48 reported benefit, which included 15 who had not yet received healing. These latter could be said to have benefited by placebo influences, although with spiritual healing, we do sometimes find that effects are felt outside time, and the very act of asking for it sets healing in motion.

CONCLUSION

So, you can see we have gone to a considerable amount of trouble and expense to show that our way of healing sick houses works. Of course we know it works, otherwise we would not be continuing to give so much time and energy to our clients in our seventies. We have masses of positive feedback from clients from the thousands of cases we have treated to date. If you want not to believe this kind of feedback we understand it is called “anecdotal evidence” and doesn’t have much validity. In Ann’s profession as a psychotherapist, feedback called “case histories” ARE valid to illustrate points in a presentation. For this reason we put some personal stories from clients in our book. Do statistics cut more ice? After all that effort we do hope so. However, as Laurence J. Peter said, “*A man convinced against his will is of the same opinion still*” – so we will see how our research is received by people whose scientific paradigm finds it difficult to stretch to the underlying concepts applied to this work.

As most dowzers accept, it is very difficult to prove that dowsing is valid for non-physical targets. We have moved further into this dilemma by testing results, first by dowsing for diagnosing the problem and what to do about it, and then by using spiritual healing techniques for effecting

change. Terry Ross, one time President of the American Society of Dowsing, in his book *The Divining Mind*, would include the healing aspect of the work in his “Seven Steps”. Level Five involves “*Making changes: the diviner goes from observer to effector*”. But when teaching people to do this work we find it best to make a clear distinction between receiving relevant information at the diagnostic stage by dowsing and moving into the proactive stage of healing to effect changes.

We offer the research based on OUR way of working, whose effectiveness we have now shown statistically. We do not for a moment think this is *THE* way; indeed it is more than likely that each dowser/healer doing this work will do it differently! However, you have now been given the advantage of a proof of validity which we hope will further enable your work in this field. If you are interested, and have the mental stamina to digest it, you can download the full report, with *all* the complicated statistical analyses, from our website (1) and we are most grateful to Barry and Heather Hoon for putting it there. It can be viewed there page by page or downloaded from a zip file for printing out. For those not able to access the internet we can supply a copy for the cost of photocopying plus post and packing. Please ask.

Some of these two articles are in the words of our statistical expert, Dr Vicky Wass, but she has not been able to share with us in presenting the paper [at the 70th Anniversary International Congress] as she has become extremely busy with a young family.

We warmly acknowledge her expertise in developing this trial and thank her for her work and dedication in analysing and reporting the results.

(1) www.dspace.dial.pipex.com/procter



John E. Emin Cot Death Syndrome

HAVE THE ANSWERS BEEN THERE ALL ALONG?

Cot death and the cause has been one particular field of work many doctors have so far struggled to come to grips with. We have heard of the wrong sort mattress sponges being harmful. We have heard all kinds of advice on what not to do to ensure the safety of a baby. We are told that there has been a downward trend in cot deaths after the advice not to place the child facing down. But in all they seem to still be struggling to find the real and deadly cause of this terrible phenomena.

Most recently we are hearing that they now think some babies are genetically deficient in some way and others have some form of illness that could make them fall to this the fatal condition.

One thing is for sure. When a mother loses her child it must be the most devastating personal tragedy she has possibly ever encountered. So what of the mothers that have lost two children and worse, even three from one

family? What then? It’s usually prison for the dastardly mother who has killed her children. Most experts for the prosecution seem to think in straight lines and say one death is possible, two is suspicious and three is proof of guilt. This thinking might now be reconsidered in the light of newer thinking on the subject.

Yes, it is possible for a mother to kill her children and cover it up by saying it must be cot death. I just do not believe the vast majority are caused this way. However, as a dowser and I hope a sensible person that can balance the probabilities of fact and fiction, it seems to me that we as dowzers may very well know the answer but have not questioned ourselves thoroughly enough on this very disturbing subject. Maybe we are in some form of denial on the subject. I say “maybe” we should stick our heads above the parapet and say what we know.

Some of the things that are well established in our field of work is, it is known that babies are sometimes seen crawled up in to the corner or one end of a cot and found

Cot Death Syndrome

fast asleep. Other babies seem to cry all the time. Yet when the cot is moved to another room the problem seems to disappear. We know about dowsing for negative and positive lines that cross the globe and for deep underground water and other problems causing negativity that can stress those living within these negative fields.

We have people that are Geopathically Stressed. Having map dowsed a client's home some years ago and returned



the plan for her to inspect, which I must say seemed not too bad as the one negative line that went through her house was close to a wall roughly where the door lock was to their bedroom. The bed was completely clear and she was notified that her house was found to be fine to live in and she had no cause to worry about being Geopathically Stressed by what I had found.

To my amazement, the lady in question was tearful and explained the reason for coming to the BSD and then to me was that she felt she was losing her mind. This problem had created a terrible stress in her marriage. I never want to know ahead of time the actual complaint as it could colour my findings but following the dowsing exercise and returning the plan to her duly completed she then told me her specific problem. She had complained that

when she awoke to go to the bathroom during the night she had a tingling sensation down her left hand side of her body going out of the room and a similar sensation to the right hand side of her body going back in to the room. I thought we might have ghosts, she said, but I do not believe in them. However, something was causing her these sensations.

Having seen the one line I had drawn in she immediately understood the problem and could then deal with it in her own way. It was clear to me that she was very sensitive to this particular negative line. Over the years I have come across a few people that say that they can actually feel depressed when sitting in the wrong place and then move to another seat and find themselves feeling better. Last year there was a case of a Cambridge college student who went to sleep during the day on a sofa and she inexplicably died of what the coroner said was cot death syndrome.

All this seems to add weight to there being an outside influence acting in some way. A young lady at Cambridge who was healthy with no known illness at the time simply died. A tingling sensation felt walking thorough a negative line. Babies attempting to get out of the way of something they obviously don't like.

Doctors and scientists have been struggling to find the cause of cot death syndrome, and in my view they may nearly have the truth. However, in any form of research the final truth can be ever elusive and take many more years before it is nailed once and for all and then maybe we can get the bottom of this terrible problem that sometimes runs in families. Yet aren't all the clues there in human knowledge, a puzzle that needs to be put together in some coherent way to form the final picture?

We as human beings are as varied as the pebbles on

the beach. We are not all alike and thank God for that. There are the strong, the brilliant, and unfortunately the weak and those that suffer many kinds of ailments and are far from being healthy.

All babies are different, each having its own characteristics. My theory, if I may call it that, says we are all made to survive on our own with our involuntary functions ensuring our hearts pump away, digestive systems work as they should and the nervous system that connects all parts of our bodies and brain are in tip top condition with a little current of electricity racing through the nerves from one point to another.

However in some cases, especially in the very young, either by a genetic defect or simply because the system has not fully developed as yet or even an illness that dampens the ability for the nervous system to function properly.

Added to the above, should the baby or even an apparently healthy young lady, as in the case of the college student mentioned above, be subjected to Geopathic stress, in my view could further dampen their ability to function properly and even shut down, or at least severely dampen the electrical signals that are normal, causing the cessation of breathing and then heart failure.

As an example, what can happen to electrical equipment when there is a massive electro magnetic pulse? With electricity the electrons speed up through the circuits and in the case of some sun spot eruptions and also with Atomic Detonations equipment can be damaged by this invisible but factual phenomena. EMP causes a form of super conductivity. What happens is an illustration that outside forces that are completely invisible and fairly rare but can have a baring on how things work.

In my theory it is the opposite end of the electro conductivity scale that I am very much concerned with.

The electrical pulses through our nervous and cell systems is relatively low. Anything that might dampen it such as an illness or a genetic fault or even a system not yet used to coping by its self, as in the case of a baby that depended on mothers heart to do much of the work, and now possibly still not quiet ready for the big world find themselves in difficulties because they have their cot placed in a negative area of the house.

I would say that some babies might have died anyway because of illness or genetic fault in some way. However, I would also say that children at risk ought to be placed in neutral areas of the house and never in a place that could Geopathically Stress them. Even better is to identify a good positive line and place the cot correctly in line with it to make best use of the recuperative powers afforded by it. I have never heard of any harm that could come to any one thus placed.

The medical profession is in the dark ages concerning this particular problem. As with all human endeavours, we always find a way to move our knowledge forward. On this occasion the doctors might be dealing with something out of their immediate field of expertise. In which case, if Geopathic Stress or some form of negativity in the home will never come to them as a contributory factor, unless there is specific research on the matter.

Maybe we might have some thought on the subject and help end this terrible waste of life.



Professor Jens Jerndal

Crop Circles – a Preview of Aquarian Technology?

At the annual general meeting with the Scientific and Medical Network in 1991, the late British architect Ann Holms proposed “inverted map dowsing” as the explanation of the crop circle phenomenon, which at that time still produced comparatively simple patterns, most of them in England.

I found her idea ingenious, and could, as it happened, back it up with several complementary phenomena in the field of parapsychology, that in my opinion make it by far the most compelling explanation to date.

“Inverted map dowsing” may not mean anything to most people, and it may not sound very convincing even to those who do know what map dowsing means. Clearly, most conventionally educated people, and particularly so conventional scientists, will reject the idea of map dowsing altogether. Yet, there is no doubt that it exists, that there are people who have the gift of tuning in to an area with the help of a map, accessing detailed information about that area without having ever physically visited it. Actually, the police have often enough used psychics who dowse maps to find missing persons. And the more recent term of “remote viewing”, developed by the military and the American CIA for the purpose of gathering strategic information, is just another name for essentially the same psychic phenomenon. So map dowsing is real, even if few people are aware of it or want to acknowledge it.

Having established as fact that the energy and information of a geographical location can be picked up by a perceptive person with the help of a map of that location from any distance, why should it not be possible for such a person to communicate or channel information and energy to the actual geographical location with the help of a map? In other words, why should such communication be limited to one way only?

I admit that perceiving information psychically from a particular field at a distance is not the same thing as being able to cause physical events in that field.

But wait a moment! First of all we have the radionic agricultural practice of treating a field – and observe that we are talking about a specific, well defined field with no spilling over into adjoining fields – for instance against insects. In these cases radionics is precisely practised with the help of a map of the field to be treated, and the practitioner does not have to be anywhere near the field he or she is treating.

This form of agricultural radionics is entirely analogous to distant psychic healing, which can be performed over any geographical distances. And in case you should now protest that this is nothing but bogus and superstition, I would like to draw your attention to the fact that a considerable number of scientifically impeccable investigations have been carried out that have proven beyond any doubt and with highly significant statistical results the reality of such healing practices, including the physical healing effect of prayer, even when the prayed-for patients were totally ignorant of the fact that they were being prayed for.

Exactly the same is true of radionic healing with the help of a so called “witness”, normally either a drop of the patient’s blood or, perhaps more commonly, a hair from the patient. The patient can be in Australia, Canada or Argentina, and the radionic practitioner in England; the

distance makes no difference. Those who now object that this is utterly unscientific and consequently perfect nonsense, need at this point to be reminded that all I have said here is perfectly compatible with the latest theories in modern subatomic physics, such as quantum mechanics and the Zero Point Field. I shall come back to these in a moment.

One step further. Uri Geller has become world famous for bending spoons and repairing clocks at a distance, even if he has been known to cheat on occasions, and therefore by many dismissed as an illusionist and a fraud. Uri Geller has become well-known because he is a showman and performer making money from his talent, but the fact is that he is far from the only one with this particular talent.

John Hasted, Professor of Physics at the London University, has been working with quite a number of young boys and girls who were all able to physically bend metal without even touching it. I personally saw him demonstrate this at a conference of Parascience in London in 1976. Professor Hasted has also been working with researchers and mediums in Russia, France and the USA. Professor Hasted is not the only one who has done this kind of research, but he is probably the best credentialed, and the one with the most consistent results.

The metal-bending phenomenon is closely related to telekinetics, demonstrated in Russian scientific experiments, and to the poltergeist phenomenon, also scientifically well established as fact. It is true that Professor Hasted in an interview in 1979 expressed as his opinion at that stage, that the metal bending effect demonstrated in his experiments could not be achieved if the medium was too far away from the object to be changed. However, we do have the examples of radionics and distant healing, which clearly do work regardless of distance.

What is it that happens when the metal is bent? – There is a disruption in the energy fields that bind together the metal atoms in such a way as to define the properties and behaviour of the object in question. Chemical analysis of the objects before and after the experiments showed that Professor Hasted’s mediums had caused atoms within the crystal structure of the metal to move and become displaced. This was done with their minds only, without touching the objects.

So when a spoon is bent, the energy field that keeps all its atoms and molecules lined up in such a way as to make it appear rigid with a certain shape and certain properties, is interfered with by psychic energy at specific frequencies. This interference at certain frequencies interrupts the electrical current, as it were, that maintains the position, relationships, and functions of the atoms in the spoon, and the structure of the spoon breaks down at a particular point. Exactly the same thing happens with the crop stems, as the crop circles are formed. Incidentally, so called psychic surgery as practised for instance in the Philippines and in Brazil, can be explained in the same way.

The kind of energy we are dealing with here, capable of interfering with and changing the informational blueprint and energy program behind a physical manifestation, is in Astrology represented by the planet Pluto and the sign of Scorpio. It is also closely related to the principles of Death,

Crop Circles – a Preview of Aquarian Technology?

Rebirth and Transformation, as from a caterpillar into a butterfly. Recycling, melting and re-moulding, as well as elimination and release of used exhausted or obsolete material, also belong in this category.

To sum up: Having acknowledged the authenticity and validity of map dowsing, distant agricultural treatment of crop by radionics via a map, distant healing, and spoon bending without physical contact, does it not then make sense that some people have been able to develop the talent of not only directing energy from afar to a particular field with the help of a map, but also interfering in a particular way with the molecular fields of the straw or crop stems so that they bend, and even in a particular direction? And bending individual crop stems is how the crop circles are formed. Ann Holms said she felt that the way the crop circles were created was by drawing the patterns on a map and then somehow generating the energy to teleport, as it were, those patterns to the crop field in question.

And here I wish to introduce two more concepts of modern quantum physics to support my hypothesis, namely non-locality and the Zero Point Field. To make a long story short, the Zero Point Field is now by many frontier scientists considered to be the ever-present and all-permeating matrix sea of energy and information out of which our physical universe is being continuously precipitated into space and time by Consciousness. And Non-Locality means that a creative impulse of form-shaping consciousness may exist independently of space and time. This, in turn means that such an impulse can pop up anywhere in space, and also that it can manifest in several time-space locations simultaneously. And, finally, it also means that such an impulse can be projected from one place to another and manifest at a location far from the one where the creator and projector of the impulse is physically located.

It is interesting to note that it all started with fairly simple circles in a certain area of England in the 1970s, the decade when the so called New Age burst onto the stage with all its focus and research into the invisible reality and different paranormal phenomena. Then, over the years, the

crop circle phenomenon has spread to many different countries, and the patterns have become ever more complex, expressing ever more advanced mathematical knowledge and symbols, and ever higher technical skills in the creation of the patterns.

The theory that extraterrestrials are behind the crop circles may have its merits, but to me the evolution and choice of patterns suggest highly educated, well informed and skilled terrestrial humans, playing games and testing the reactions of public and experts alike, while gradually developing and perfecting their unusual skills over the years.

I agree with Paul Vigay when he feels that the sensational ET face manifested in August 2002 at Crabwood Farm near Winchester suggests inspiration from Hollywood and Star Trek, rather than real ETs, if they do indeed visit us. And also that the binary coded disk relates more to contemporary human information technology than to anything likely to flow from ET minds. As for the message that a data specialist deciphered from it, it sounds like an unspecific condemnation of defective morals and ethics, a constant in human nature since Adam and Eve. Though admittedly such a condemnation may be more relevant than ever before, when applied to contemporary politicians in a global setting.

Likewise, the Mandelbrot fractal patterns appearing some years back seemed to follow a sudden rise in awareness among intellectuals and vanguard scientists of this new and fascinating branch of mathematics.

Perhaps one day the creators of this mystery will step forward and explain how they did it, and why? That could be the day when Humanity at large, including scientists, will have to acknowledge the existence of an invisible reality far greater and more important than the visible world we can register directly with our senses. That would be a definite breakthrough for the emerging Aquarian Paradigm.

*Professor Jens Jerndal, M.D.(MA), M.Sc., B.A. 2003
e-mail: JJ@life-expansion.net*

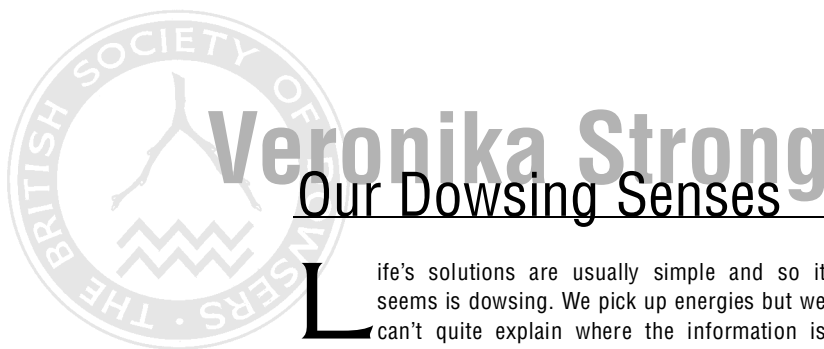

Life's solutions are usually simple and so it seems is dowsing. We pick up energies but we can't quite explain where the information is coming from and how to interpret the information.

The information is relayed by our senses. Our senses make us aware of what is going on around us. We see, hear, feel, taste or smell. However the awareness of what we sense is limited. Our awareness is the level in which we perceive and understand everything that is going on around us, but our senses may limit our awareness.

The eyes, although our sight is not bad but we only

can perceive the colour spectrum from red to violet. If we want to see more we either need X-ray machines or special infrared equipment. Animals like birds, insects and night living creatures have much better sight than we have.

Some animals have extraordinary eyesight. Birds can see from high above the ground when a small animal, like a mouse, or even an insect, move on the ground.

The night animals in the jungle, such as Possums see little insects in complete darkness, which is far beyond our awareness and we need special equipment

Our Dowsing Senses

to see of what the animals can see naturally. It would be easy to say it does not exist but we do know it exists, we are just not aware. Our senses limit us.

Hearing – although our hearing is quite good it is again limited. Our elderly corgi can hear a hot air balloon miles away when it is hardly visible and she will let us know. We all know about bats and their extraordinary hearing.

The elephants communicate at great distances with a very low rumble between different herds, yet we can't hear it, we can only detect it with special computer enhanced equipment. It is also said that the elephants pick up sensory information from one herd to the other through their feet. We are not aware of the sound nor the vibration.

It's the same for the sense of smell. Dogs are used for tracking from drugs to humans – yet our sense of smell isn't good enough to keep us on a track. Insects smell the tiniest fraction of a scent miles away. Again, we realise it exists, but our awareness is limited.

So here we are multi-sensory beings with only limited awareness. We can't say nothing exists beyond our awareness as we do know it is all there. So what is happening?

If we were aware of every sensory information that is going on around us it would cause an information overload. There are many thousands of sensory messages every second of our lives and if we had to process each and every one of them we would simply go mad. All the information gets lodged in the subconscious mind, which after all runs our body. If we were aware of every breath or heart beat, and for that matter every function in the body, we would have no time to do anything else. The subconscious mind only releases information to the conscious mind which is either of benefit or when we are in danger. In other words, we don't notice our body temperature – only when we are too hot or too cold or we notice our breath when we are out of breath, our heartbeat when it is too fast.

I am sure you will all remember the story of the fire chief yelling at all his fire fighting men, when they were in the middle of a burning building. They were to stop immediately and get out quick. This is usually not what fire chiefs do! In this case – as the last one got out, the whole building collapsed. Something in the fire chiefs mind had alerted him to the danger, and as a consequence he managed to save all the men's lives.

There is another phenomenon of the example of a mother with a new baby. If the mother was to sleep in another room away from the baby, surrounded by all sorts of noise, with children playing somewhere else in the house, music going and with traffic noise outside this mother would sleep through it all. But if the baby next door would just as much as make a little noise (without a baby monitor) the mother would be awake and alert in an instant. How can we explain that? She sleeps through all the loud noise but the tiniest noise from the baby and she is wide awake. There is no foreboding danger in this case.

Our awareness is in a constant state of flux,

however at the moment of any action or decision something seems to change. We can only do what our awareness allows us to do. To stop us from going mad with the thousands of sensory messages bombarding us all the time our brain has a protection in place. This system protects us from a brain overload, it is called reticular formation or reticular activated system. A network of nerve cells are scattered throughout the brainstem and the base of our brain. The brainstem is the so called highway of messages and controls several of our subconscious automatic functions such as breathing, eye reflexes etc. The work of the brainstem is below our consciousness and operates largely on an automatic basis. This reticular activated system is acting as the watchdog on sensory information alerting the higher brain centres to either new or important sensory stimuli that need a conscious response.

So these reticular formation cells will allow information to get through which is either of benefit (Mother and baby) or to alert us to danger (firemen). How often do we get a sudden 'message' to change direction or stop what we are doing. Our subconscious mind has all the information but we only let through to the conscious mind, what WE NEED to know.

So what has that got to do with dowsing?

Most dowsers I am sure are aware of toolless dowsing – which means we use body signals to get a 'yes' or 'no'. Whichever main sense we use for non-verbal communication (see, feel, taste, smell or hear), will be the easiest to use for toolless dowsing.

How many dowsers feel geopathic stress with their hands, or in my case, get instant cold feet. There are people who clearly hear a warning if in a dangerous situation, or see an aura, taste danger or smell a change in life.

We pick up with our bodies, all the energies around us, even though we may not be aware of doing so. When people get ill in a geopathically stressed house their body is simply giving them a message.

Nearly everyone with geopathic stress in the house will confirm that they don't know why, but they usually don't like the house or have a 'feeling' in a particular room and that they don't sleep well. All messages from the body to alert the person to some kind of danger.

So as dowsers we are asking question which WE NEED TO KNOW the answer to. For the answer, we need to extend our awareness, after all – all the information and knowledge is in our subconscious.

Have you ever wondered that you never noticed something before, and when it becomes of benefit or pay value – you see it everywhere! Take a car for instance. You want to buy a new car. As soon as you make up your mind of what you want, from that moment on you see that car everywhere. That car hasn't come out of nowhere, it is only your awareness that has changed.

Dowsing is an extension of our awareness to get the answer on a 'NEED TO KNOW' basis and the answer will be released from the subconscious mind as soon as it is of benefit to us.

Does that not make sense?



Shivani Ariuna

Electrical Pollution

WHAT'S IT DOING TO YOU AND YOUR CLIENTS?

In the past year, I have taken a crash course in electrical pollution. I crashed, so of course I had to find out why in order to remedy the situation! What I have learned and experienced have convinced me that electrical pollution is a major cause of health problems in the USA.

Electrical pollution, invisible, silent, odourless, tasteless, is the perfect pollutant. We have not evolved any methods of sensing its presence. A few people, like me, have become "electrically sensitive" and are able to know when we are being exposed due to immediate symptoms that we experience, but most people, even if exposed to levels and wave lengths that are literally killing them, notice nothing. Everyone living in areas of the world with electricity is being negatively affected. It is only a question of degree. (Dr. Neil Cherry, Evidence that Electromagnetic Radiation is Genotoxic: the implications for the epidemiology of cancer and cardiac, neurological and reproductive effects. His presentation to New Zealand Parliament in May 2000, European Parliament in June, 2000. Look for link at www.electricalpollution.com/Monumental.)

Electricity is termed "dirty" or polluted when the normal 60 cycle sine wave carries with it various high frequencies, which damage electronics and living beings. Industry and large corporations spend billions to protect their electronic equipment from this, but nobody is looking out for humans. The present pollution is created as electricity passes through anything electronic, which "chops up" the sine wave and then dumps these high frequencies into the current as it is passed on. This RF (radio frequency) energy causes neurological, cardiac, respiratory, ophthalmological, dermatological and other conditions ranging in severity from headaches, fatigue and ADD to pneumonia, psychosis and strokes. ("No Place To Hide" Volume 3, Number 1, April 2001, "Special Issue on Russian and Ukrainian Research" by Arthur Firstenberg. Article can be obtained at (718) 434-4499 or see at www.electricalpollution.com/). Childhood leukemia is markedly higher in areas with electrical pollution. (Savitz, D.A. et al. 1988. Case Control Study of CHILDHOOD CANCER and Residential Exposure to 60(c)Hz Magnetic Fields. American Journal of Epidemiology 128(1):21(c)38.)

In "the old days" before electronics, electrical power was polluted at the source, by brushes in the generators. A monumental epidemiological study using childhood leukemia as a marker found an absolutely correlating increase in this disease in areas of the USA, Africa and Europe as they sequentially became electrified. (Samuel Milham & E.M. Ossiander, Historical evidence that residential electrification caused the emergence of childhood leukemia peak, Medical Hypotheses, vol.56, #3, 2001, pp.290-295). Generators now produce clean power but modern pollution levels are much higher due to electronics.

For every electron that leaves a substation, one must return. As electricity polluted with high frequencies likes to spread out in what is called the skin effect, the presently inadequate utility wiring system causes 70% of the return current to flow across the surface of the earth. Most people think the earth soaks up electricity like a sponge. It does not. Electricity just flows over the surface, like water over a brick. This ground current is attracted to, and enters your home on water pipes, gas mains and phone lines, greatly increasing the amount of high-frequency exposure you already have from your own electrical service. Various metal structures in

your home, from wiring and lamp cords to fins in electric baseboards and the metal springs in your bed actually broadcast these harmful frequencies right through your body 24 hours a day, whether or not any electrical appliances in your house are turned on. In many places attempts to ground bring in more current than they take out!

You may have read that strong EMF is created by your refrigerator, hair dryer, etcetera. This is true, but the electronics in your house are really quite a small part of the picture as electricity is already extremely RF-polluted when it enters your home, from everybody "upstream". It is not commonly known even by those who write on this subject, nor by many who do professional remediation, that the RF is the main culprit.

Doctors are as unaware of this situation as everyone else, so the best way to determine whether someone's health problems are related to RF is to lower the RF levels and see what happens. In schools and homes where RF remediation has been done, many kids with Attention Deficit Disorder suddenly don't have it any more, and teachers with mysterious maladies that kept them from working a full work week now don't miss a day. Many chronic headaches and complaints of chronic tiredness melt away. (Melrose Chronicle, Melrose, WI 2/26/03). Kids who had such severe asthma they needed nebuliser treatments no longer do. Many diabetics find that their need for insulin drops dramatically or even ends when they avoid RF, and conversely that it increases when they are exposed. (My friend and mentor Dave Stetzer's blood sugar skyrockets within minutes when he is exposed to RF, which seems to be the sole causative factor. To date, the blood sugar of every person he has tested is affected within minutes). Cows give up to 10 more pounds of milk per day on the days when the RF in their environment is low (Donald Hillman et al, Relationship of Electric Power Quality to Milk Production of Dairy Herds, Shocking News, 9/11/02, also avail. at www.electricalpollution.com/), and 20 pounds more if power quality is remediated and remains clean. (Conversation with power quality expert Dave Stetzer). I myself have needed less and less thyroid hormone as my electrical environment has been improved, yet notably more on days with more RF exposure..

My own story illustrates both the effects of RF exposure and the challenges of dealing with them in a meaningful way. We live in rural Wisconsin, in a Winnie-the-Pooh three-acre beech and maple woods surrounded by farm fields and more woods. Deer and an occasional wild turkey wander through the yard and organic garden and the loudest noise is made by crows. Not a place where you'd expect to find dangerous environmental pollution. About a year ago, I began to have "spells". Although I have always had low blood pressure, I began experiencing spells of a sudden and sharp rise in blood pressure with skyrocketing pulse rate and frightening cardiac arrhythmia. I was taken to the ER by ambulance twice, but by the time I got there pronounced normal. \$18,000 worth of medical tests found nothing to account for these and other bizarre symptoms, so doctors finally pronounced that I was having "panic attacks" and prescribed beta blockers, which force the heart into a regular 72 beats a minute and turn you into a zombie, in my experience. I refused them. Insomnia increased to the point where I was sleeping, in broken bits, from 3-5 hours a night. I felt as if I was made out of paper. Sometimes just breathing and walking were very taxing. My anxiety level was extreme, my adrenals were exhausted and my thyroid

Electrical Pollution

needed help from hormone replacement. Already slender, I became a shadow. I wasn't sure I was going to survive.

I became "electrically sensitive", a sort of walking EMF meter. I would experience symptoms if I went near a TV, a telephone, a car fan, the computers in the post office or bank, the chair in the dentist's office, the water pipes in our house

At least now I had a clue. I was very fortunate to be put in touch with power quality engineer Dave Stetzer, who graciously taught me about power quality and what I needed to do to clean up my immediate environment and save my life. We did experiments and took readings with a variety of meters and gizmos, indoors and out. We put in shielded phone lines, moved water pipes, replaced the first 4 feet of our water pipe with PVC, (helps 50%, RF still comes in via the water itself), gutted old electric baseboards that though disconnected were broadcasting RF over large areas including our bedroom. We installed RF filters, took out dimmer switches and fluorescent lights, sold the aquarium, got me a speaker phone and a laptop computer I use on battery only, and I avoid the high-field parts of the yard.

With each of these steps results were immediate and dramatic. The cardiac symptoms ceased. I was able to sleep. My anxiety level dropped. My recovery has been steady and I am now quite well. Only, however, to the extent to which I am able to avoid RF! I remain electrically sensitive to date. My reactions to RF have changed, however, from cardiac events to intestinal spasms and fatigue, which are definitely preferable. This change occurred after classical homeopathic treatment, as a result of which, I understand, one tends to be relieved of symptoms from the top gradually downward in the body. The other "side effect" is that I became an electrical-pollution educator and activist.

This article is just the tip of the proverbial iceberg. Toxic electricity is a chronic, severe stress, affecting virtually everyone, that only increases as the pollution proliferates. I offer the following points and ideas for your further consideration.

- I know a Polarity Practitioner who wonders why many of her clients, in spite of doing "all the right things" still have such serious problems. No one has thought to check what RF they are living in.
- I used to give sessions to a woman who lived across the street from a hefty electric cable. No matter what I did, nothing happened! It was so bizarre, as if something was cancelling out the energy. Finally I became aware and took meter readings. Her apartment had EMF high enough to cause childhood leukemia. What was that doing to her? To me? To the Polarity sessions?
- Under this stress, do people develop different conditions due to their own inherent weakest links, so to speak, one getting diabetes while another develops Chronic Fatigue Syndrome? What role do astrological aspects and transits play?
- The particular wavelengths one is exposed to are relevant, as is the strength of the field. As these two vary, different "windows" are created, with varying effects. US military research shows that particular wavelengths cause different symptoms. (Charles Polk & Elliot Pastow, *Handbook of Biological Effects of Electromagnetic Fields*, 2nd ed. 1996. The military knows the specific wave lengths to cause depression or rage or incite crowds to riot). Also, each individual is a unique receiving antenna. For instance, one's height affects which wavelengths one receives most easily. (Polk, *ibid.* chapter 9). Weight and fat/water content play roles, as do metals in the body. (C. Polk & J.H. Song, *Electric fields induced by LF*

magnetic fields in inhomogeneous biological structures... *Bioelectromagnetics* vol. 11, 235-249, 1990). I and many others experience much more affect from broad area RF when lying down than when standing. This is not so strange, as research shows ants realign the way they hold their antenna and bodies when they are exposed to EMF. (B. Blake Levitt, *Electromagnetic Fields*, Harcourt Brace, 1995). Not only is our "antenna" tilted at a different angle why we are horizontal, but we also have greater electrical potential the further apart our "poles" are. This is one reason livestock suffer so much.

- Another factor is that the loads on the electric lines are different at different times. And flow on Earth's EM grid lines is said to reverse at certain times of day. (One of these times is midnight, when I had more "spells" than at any other time of day).
- The belief that only ionising (heating) radiation can harm living organisms has absolutely been proven wrong, yet persists as the basis for "official" exposure guidelines.
- The current induced in the body is a product of field strength and frequency. A field oscillating at 180 Hz induces three times the current in you as a 60-cycle field does. In such a field, every cell in the body will experience a shift in polarity 180 times a second!
- Living organisms are sensitive electromagnetic systems that run on millivolts. Vanishingly small charges far below the threshold of awareness affect them. (Exposure guidelines set by utility-supported "experts" are still based on voltage. Remember that the frequency of the field or current is the key factor!)
- Our natural body currents are DC. Earth itself has a very strong DC field with which we evolved. AC is damaging to living systems, inducing currents within them which DC does not.
- The Earth's field fluctuates with time of day. Different organ systems of the body are more energised at different times of day. In fact, sensitivity to the minute fluxes in the Earth's natural magnetic field is the most important component of our circadian rhythms. (Levitt, *ibid.*, 118-120). How are these affected by EMF?
- We are particularly sensitive to EMF during sleep, the time when various healing activities take place in the body. (It is interesting that the front-to-back polarity of our brains reverses during this time), (Levitt, *ibid.* 133). The effects of spending eight hours asleep in toxic electrical field are very serious. If in addition such an area is on a planetary grid line, cancer is very likely. (Before electrical service was available, research showed 95% correspondence between cancer and sleeping on such lines). (Gustav Freiherr von Pohl, *Earth Currents: Causative Factor of Cancer and Other Diseases*).
- Dowzers, who use the magnetite in their foreheads while dowsing, as animals do for biolocation, say that ground currents are travelling specifically on the Earth's magnetic grid lines. In Europe, particularly in Germany, baubiologie practitioners check homes for such dangerous lines.
- The polarity of cells is disrupted by EMF and currents, with profound effects. Healthy cells have: polarised walls with positive charge outside, negative inside; few and small pores in cell walls; calcium ions mostly outside cells; ability to communicate with other cells via molecules; ability to attract attaching information-bearing molecules. Their ability to choose what to allow in and out depends on electrical charges on ions like calcium, sodium, proteins, sugars, hormones, etcetera, as well as pore size and cell wall polarity. Cells affected by EMF and currents: lose polarity; have calcium ions equally inside and out;

Electrical Pollution

lose ability to manufacture enzymes; have cell walls with more and larger pores; allowing waste molecules to penetrate the cell. If the field or current is of long duration, the cells die. This is called electroporation. (J.C. Weaver, Molecular basis for cell membrane electroporation, *Annals of the New York Academy of Sciences*, Vol.720, pp.141-152, 1994. Several more references listed in CURE booklet).

- Melatonin production is decreased by exposure to EMF. Though most known as the hormone necessary for good sleep, melatonin has such numerous functions that health is not possible when it is insufficient. Besides regulating our internal clock, it affects gonadal hormones, moods and behaviour and the immune system and exerts direct effects on the growth of cancers in the breast, prostate and colon. 1(R.P. Liburdy et al, ELF magnetic fields, breast cancer and melatonin, *Journal of Pineal Research*, vol. 14, p.89, 1993).
- Safety standards are based on exposures considered safe for the average adult male, however children are more affected by EMF than adults. The greater the cell division rate, the more chances for something to go wrong, and the growth processes themselves are affected by EMF, babies in utero being most affected. Field-created defects are permanent and are passed on to succeeding generations, for instance the inheritance of brain-tumour tendency in children of men with high occupational exposures. (Dr. S Nordstrum, "Effects of paternal EMF exposure on offspring, *Bioelectromagnetics*", vol.4, pp.91-101, 1983). "There may also be frequency-specific windows for different organ systems, meaning that certain exposures may be particularly detrimental at fixed times during fetal growth." (Levitt, *ibid*).
- Resonance occurs when an aspect of a force, such its wave length, matches a characteristic of an object receiving the force. This allows the power inherent in the force to be maximally transferred to the object, causing it to vibrate. (The crystal goblet when the opera singer hits high C, for instance). Within the object, the resonance is self-perpetuating! You and I are objects being thus affected. Similarly, trees resonate extremely well to microwaves, leading to deforestation, particularly in mountainous regions where the microwaves bounce off the angles of the slopes. (Wolfgang Voldtrodt, *Electromagnetic Pollution of the Environment, Environment and Health: A Holistic Approach*, ch. 8. Avebury Press, 1989).
- Dr. Robert Becker theorises that healers can sense a disease site in a person's body through radiating an electromagnetic field from their hands which induces EM resonance in the patient, the return signal then being felt by the healer. A resonant action occurs between the fields given off by the healer and the intrinsic electrical-control systems within the patient's body. "While these currents have a vanishingly small flow, they would nonetheless produce local DC magnetic fields within the tissues. These fields, in combination with a frequency given off by the healer, could result in resonance with other charged particles." As the theory rests on complex resonance, the Earth's magnetic field must be involved. Therefore, Dr. Becker reasons that healers will have greater diagnostic and healing ability during times of quiet geomagnetic field conditions and those abilities will be adversely affected by magnetic storms and locations in which man-made magnetic fields or extra low frequency (ELF) fields are present. (Becker, *Cross Currents*, 240-241). An important issue for Polarity therapists to consider and research!
- Cyclotron resonance enables very low-strength EM

fields, acting in concert with the Earth's steady-state magnetic field, to produce major biological effects by *concentrating the energy in the applied field upon specific particles*, such as the biologically important ions of sodium, calcium, potassium, and lithium. This resonance is produced by frequencies between 1 and 100 hertz. European electricity is 50 hertz and N. American is 60 hertz! Yet safety standards have been based on power, not frequency. (Becker, *ibid*. 235).

- Dr. Becker believes "That humans interact so fundamentally with the earth's magnetic fields...may be the most important biological discovery of the 20th century." It may also be a hidden variable in all research.
- The effect of microwaves is also vital to understand. One point to be aware of is that microwave exposure breaks down the blood/brain barrier. (Bertril R. Persson, Blood-brain barrier permeability in rats exposed to EM fields used in wireless communication, *Wireless Networks*, Vol.3 #5, pp.455-561, 1997. Also learn more at www.microwavenews.com/).
- Regarding effects of eating microwaved food, see article at www.mercola.com/article/microwave/hazards.htm i.e. habitual eating of such food causes long term permanent brain damage by "shorting out" electrical impulses in the brain due to depolarisation of the brain tissue.
- Dreadfully fascinating is the military use of electricity and microwaves. Electromagnetic pulse (EMP) weapons technology used in the Gulf War is apparently responsible for a good deal of the damage to veterans resulting in Gulf War Syndrome. The symptoms are almost exactly those of RF toxicity. The GWEN and HAARP ground wave transmissions are another silent and imperceptible exposure for Americans. "GWEN is a superb system, in combination with cyclotron resonance, for producing behavioural alterations in the civilian population." The military has also developed high-power pulsed microwave weapons that penetrate all bodily systems. These couple with the central nervous system and yield "prompt debilitation" (Becker, *ibid*. 303-304).

As Polarity practitioners, we know that the entire body is an electromagnetic energy system. We need to learn as much as possible about how this system is affected by external electric fields entering the body!

Presently, no one is looking out for individuals regarding EMF. Both military and utility establishments exercise their undemocratic freedom in ways very harmful to the citizenry. We must educate ourselves and take protective measures on our own. How to do this will be the subject of the conclusion of this article, in the next issue.

RESOURCES: Get a good introduction and read about the RE filters at [www.electricalpollution.com.](http://www.electricalpollution.com/), or at Dave Stetzer's site, www.stetzerelectric.com. Click on "power quality". See also Dave's concise and powerful testimony in the case of MI vs. their electric utility. See also <http://emfacts.com/>, www.ortho.lsumc.edu/Faculty/Marino/Powerline/ and www.emfguru.org.

B. Blake Levitt's book, ELECTROMAGNETIC FIELDS, is a treasure chest of information, including much not elsewhere readily available on the effects of EMF on animals and plant life. Dr. Robert O. Becker's book, CROSS CURRENTS, is a "must read" as well. C.U.R.E. (Citizen's United for Responsible Electricity, a small group of dedicated folks in WI) puts out an information packet that includes an information-packed 17 page booklet that includes 200 references. Call 715-564-3362. (I suggest a \$5 donation).



Stephen Tollyfield

Alfred Wills and Leicester Gataker

Around the start of the last century, General R. H. Jeff of Offcote Hurst, Ashbourne, Derbyshire had a water problem. He wanted the services of a water expert called Leicester Gataker, but he was unavailable. Gataker sent his assistant, my great grandfather, Alfred Wills. The General showed my great grandfather the field he wanted to find water in. Alfred "...strolled about with eyes closed and fingers extended."

He pointed to "...a corner of the field that was nearly always wet. (But [Alfred] had never even been there.)"

The General goes on to record, "I struck a well at the point indicated, and though it is nearly the highest point in the country round, at about 50 feet such a splendid supply of water was found that the well fell in!"

Leicester Gataker was the son of Captain Melmoth Gataker of the Bengal Staff Corps. He was educated at Bath College and might have spent his life in a London office had he not discovered his ability as a water diviner. Certain health concerns also made the office life undesirable. He started dowsing around 1890. He was initially based in Weston-super-Mare, but later moved to Bath.

Alfred first met Leicester Gataker in 1896. Gataker as a professional water expert regularly subcontracted the work of water extraction if his clients had not arranged this for themselves. At the time he had determined that an old well on Little Salsbury only required deepening by two feet to be useful again. However the job was extremely dangerous as the sides of the well were very rotten. Alfred, who worked with his father in a plumbing business, took the job – against his father's advice – and completed it successfully.

Soon after they did a job together at Ashbittle Rectory where they predicted and guaranteed water at 150 feet. A price was quoted which included pumps and tanks. The job was expected to take three months as it was anticipated that the boring would be through solid rock. In the event a pocket of clay reduced the time to just three weeks. The reduction in cost therefore made the job extremely profitable. They had taken this job on a "no water, no pay" basis, for which a 25% premium was also added.

When the time came for settlement the vicar complained at the cost. Gataker went to see his family lawyer who suggested a 25% reduction as a compromise. When he told Alfred, Alfred told him not to settle in these terms. They would not have been paid at all had no water been obtained. They had all the risk and were entitled to the rewards. Alfred, an ordinary workingman, wrote two letters and sent one telegram that resulted in payment in full. Gataker's lawyer never forgave him for it.

Alfred had learnt to be canny in business from working with his father. His father however was opposed to Alfred's connection with Gataker, which soon included the actual water divination when Gataker was unavailable. Alfred argued that it paid better than plumbing, which was certainly true. Alfred's grandfather, a Master Plumber had died insolvent. Alfred could expect only about

£3 a week from plumbing and was anxious to supplement this. Gataker got an associate with business sense, technical expertise and trade connections.

However the serious money came with overseas contracts. Gataker was engaged by the Egyptian Government and took Alfred along. Alfred would be paid £100 for six weeks' work. It gave him a taste for foreign travel that he was never to lose. He saw Alexandria as being, "Much more up to date than Bath." These were ideas that would influence his political life. Already radical in politics he would see things that gave him a global perspective.

They were successful in Egypt and were asked to do further work for His Highness the Khedive, Abbas II in Cairo. Gataker was taken ill here and Alfred carried on alone. Driving past the barracks of the XIII Lancers in the Khedive's coach "Alf Wills the Plumber" would be regularly saluted by "one of the aristocrats of England."

Later Alfred went out to Tunis, then a French colony in North Africa. This must have been in 1898 because Alfred relates that the recapture of Khartoum occurred whilst he was there. The French Governor engaged them. Workmen from Bath were sent out to carry out some of the works, but Alfred used local labour to start the initial well bore. The Arabs were Muslim and Alfred's gang all thought he had, "dealings with the Unknown." Indeed one of them told him through his Maltese interpreter that he had an evil spirit as only the devil could "twirl the twig" as he did. This particular worker would not even let Alfred's shadow fall on him.

Alfred would never have accepted that there was anything demonic in what he did. Alfred had been converted to Nonconformist Christianity as a young man. He remained a committed member of Argyle Congregational Chapel in Argyll Street to his dying day and was a frequent lay preacher at many small chapels that could be reached from Bath. Captain Melmoth Gataker and his wife however attended séances, which were popular with Bath Society towards the end of the nineteenth century. Alfred attended one in Daniel Street and some months later was prevailed upon to attempt clairvoyance. He claimed not to have done so again and disclaims any connection with Spiritualism in his reminiscences. Nevertheless, I doubt that Leicester Gataker would have trusted Alfred to appear as his representative on so many occasions had he not thought Alfred to be the possessor of some psychic abilities.

A few years later Alfred went to Portugal where he was engaged to find water for the paper making mills of a Scottish Firm somewhere near to Lisbon. According to his unpublished and incomplete reminiscences he was feted in Lisbon and entertained at the British Club because of a "daring test" he undertook. The details were apparently reported and it would be wonderful if I could ever verify his account. He was however appalled at the labour conditions in Portugal.

According to family tradition he also met the late Queen Mother as a young girl in a kitchen, but the story does not appear in the reminiscences. However, there is an undated reference in Gataker's publicity brochure to work done for the Earl of Strathmore and Kinghorn at Glamis Castle: "Several wells were sunk on the estate at spots indicated by Mr Gataker with results varying from 2 to 5 gallons per minute and in one instance was within yards of an unsatisfactory existing well."

This is not the only example of work done by Leicester



MR. LEICESTER GATAKER



MR. A. W. WILLS, BATH, ENGL.

Alfred Wills and Leicester Gataker

Gataker for the aristocracy and I am surprised that he is not better known. Alfred would have often gone along, if not to divine, then to provide the ancillary plumbing services.

Alfred's Radical politics and Nonconformity cost his Bath business work, but this was more than offset by the income he made from his connection with Leicester Gataker. In the end Alfred's politics and business led him to become Mayor of Bath. A tree he planted in Sydney Gardens was recently given a new plaque. Undoubtedly Alfred had

certain natural abilities, but I doubt he would he would have achieved so much without the economic and life opportunities he got from Leicester Gataker – someone I had never heard of until about a year ago when I started pouring through an old trunk containing Alfred's writing and memorabilia. Included in the trunk was Gataker's business brochure in which the photographs appear. Apart from this and a fairly lengthy passage in *The Divining-Rod* I have not been able to find anything else out about him.



Gunther Schneck

The Danger of Weak Radiation in the House

Radiation appears to be a neglected aspect in the investigation of geopathic stress.

The public is aware of the danger of radon gas in houses and tests can be done for it. Radon is a radioactive gas which develops during the breakdown of uranium to radium. What seems to be neglected is the formation of radon gas in pockets underground. These radon pockets give off a strong dowsable reaction which seems to be more dangerous than any "normal" water lines in the scale of geopathic stress. Of course if water lines contain uranium particles which are breaking down into

radium and polonium giving off radon in the process, this would be a very "black" water line indeed.

Chemically the damage done by radiation is caused chiefly by the breakdown of water molecules) which

make up most of the mass of living tissue) into highly active fragments ("free radicals"). The free radicals react with the complicated molecules in the tissue.

Uranium is a fairly widespread substance, 400 times more common than gold. However, only a small part on certain locations is actively breaking down. The danger of radiation is caused by artificial nuclear fission. The physicist Isaac Asimov who wrote as early as 1972 said, "Already the United States has stored millions of gallons of radioactive liquid underground and it is estimated that by AD 2000 as much as half a million gallons of radioactive liquid will require disposal each day."

The radiation danger is caused by nuclear bombs, testing of nuclear bombs, nuclear energy production, waste disposal plus accidents which have happened to increase the contamination of the soil and subsoil with radioactive substances.

The author moved into a bungalow in a newly built estate about 4 years ago with his knees not right, but fairly OK. Now the knee joints are gone and need replacement. The bungalow was thoroughly checked by dowsing and a number of minor disturbances removed. However, every

morning the knees were painful and poorly, worse than on the evening before. A geopathic disturbance was always felt. During the course of time, all man-made disturbances were removed, including the nowadays common microwave beams. Whatever was done – nothing helped.

Then I came across an article about "sick houses" mentioning that some ceramic tiles give off weak radioactivity. The tiles in the bungalow were dowsed for radioactivity, nothing was found. However, in the process, I dowsed the walls as well. I found a positive, dowsable radioactive reaction arising from the plaster boards, whereas on the concrete part of the walls without plaster boards, nothing was found. From all the plaster boards emanated a field of low level radioactivity, varying from about 50 to 80 cm into the rooms. Eventually dowsing showed that the plaster boards contained traces of uranium and radium, actually giving off three layers or fields. The strongest was from uranium, the others from polonium and radium in the form of weak gamma rays. This was a shocking discovery. As our beds were put against the wall, as most beds are, our heads were under the influence of these low level radiations all night.

No record could be found about dowsing of plaster boards for radioactivity.

With radiation, both the strength of the radiation and time of exposure matter. Here was exposure to very weak radiation but over a long time. As it always happens with geopathic stress, the disturbance was going from the weakest point in my body – the knees. The beds were removed from the walls and since then the feeling of a disturbance has gone. In retrospect, it was observed that the best chair with a nice view, which stood in a corner fairly close to both walls, was hardly ever used. Another unusual observation was that in an estate of 30 houses, 8 were put on the market for sale in the first two years. As uranium has a half life of 400 million years, one can not hope for time to solve this problem.

It would be interesting to dows plaster boards in newer building and compare with plaster boards going back more than sixty years. It could be that only some batches are contaminated, but in the two sizeable DIY stores so far investigated, all plaster board produced by two different large firms showed weak radiation. This could be a great problem. It will of course be denied, especially by scientists, as evidence found by dowsing is not going to be counted.

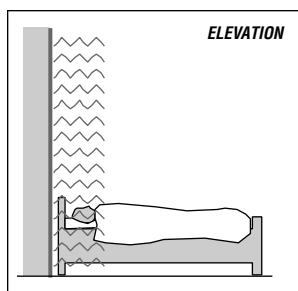
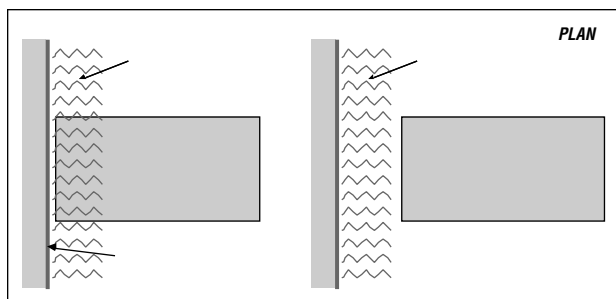

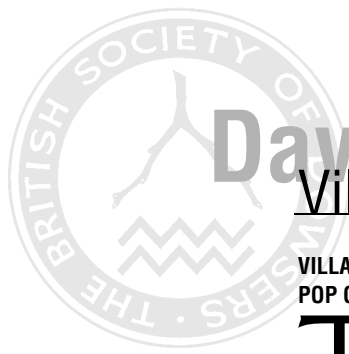

David Dixon Village Water Appeal

VILLAGE WATER RECEIVES DONATION FROM VIRGIN POP CONCERT

The Society has received another important donation to its ever-growing Village Water Appeal.

The 2003 Virgin VFest at Weston Park, Staffordshire, attracted a sell-out audience of 70,000 people, yes, that's seventy thousand, the legal maximum allowed, paying ticket prices of £80 per head for the weekend – and it was sold-out more than a month before the event held on August 16 & 17. Top name bands included Coldplay, Red Hot Chili Peppers and Foo Fighters.

Organisers Roseclaim announced that Village Water was to be one of the beneficiaries of the charitable collections made in the VIP hospitality area during the Concert and we have received a cheque for the sum of £500.00. Other charities to benefit were Oxfam, MAG (Mines Action Group) and the Samaritans.

This sum is also additional to the £1523 proceeds from a bucket collection made by some 20 Village Water volunteers – donations by concertgoers as they entered the main arena on both days of the event. We were also grateful to be able to reward our young volunteers with

complimentary weekend tickets given to Village Water by the organisers.

LONDON PETROPHYSICAL SOCIETY MAKES DONATION TO VILLAGE WATER

A notable donation to the Society's Village Water Appeal was received on Monday evening November 17th when a cheque for £100 was accepted at the Annual General Meeting of the London Petrophysical Society held at the home of its parent body the Geological Society of London in Burlington House, Piccadilly.

BSD Vice President David Dixon had been invited to make an address to members of the LPS, mostly downhole logging scientists from the oil industry. His subject Dowsing and Village Water Supplies for the Third World was welcomed and the purpose of humanitarian aid was appreciated.

After the lecture, members were invited to try a selection of rods and pendulums and most were able to obtain a dowsing reaction over the location of two water pipes running under the floor of the lecture hall.

The donation brings the total Village Water fund to a figure close to £22,000.

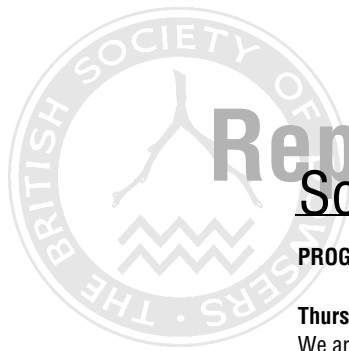

Reports from Groups South Herefordshire Dowsers

PROGRAMME 2004

Thursday May 6th - Water Dowsing, Gordon Wright.

We are hoping to meet BSD Administrator, Ian Clements, at the May meeting.

Thursday June 3rd - Dowsing for Earth-Bound Spirits, Elaine Luckhurst.

Weekend 26th/27th June - Tracing the Bluestones (Somerset Levels to Stonehenge)

Thursday July 1st - Earth Energies - the Complete Spectrum, Billy Gawn (his flight confirmation awaited)

Sunday 4th July - Group Summer Picnic (venue etc subject

to confirmation).

July (date to be confirmed) - 4 Day trip to Pembrokeshire

August - No meeting, but field trip will be arranged.

Thursday September 2nd - Dowsing, Healing & Working with Spirit, Alan Peskett.

Thursday October 7th - Electro-sensitivity in Ross-on-Wye, Ann Silk

Thursday November 4th - AGM

Thursday December 2nd - Christmas Meal

Date to be confirmed for a Field Trip to Tewksbury Battle Fields (late June), a Field Trip to Goodrich, a possible day trip to Stonehenge and a Crop Circle Day.

East Midlands Dowsing Group Annual Report

ANNUAL REPORT 2004

The group A.G.M. was held on the 9. 1.04 at the Memorial Hall, Bramcote, Nottingham. John Wright, chairman, Linda Darlison, secretary, Dudley Bendall, speaker secretary and David Johnson, treasurer were re-elected. Peter Platten agreed to accept the post of vice-chairman.

Over the past twelve months a concerted effort has been made to publicise the group and its activities, with some extended coverage being given in both the Derby and Nottingham evening papers, plus a mention in a number of "alternative" publications.

Our monthly indoor meetings are usually attended by about half of our membership of twenty-four. There have been

six well-received speakers, largely but not entirely with complementary and alternative therapies as their theme. Through the year there have been eight Sunday site visits. Such visits are, initially, chosen because of archaeological or historical relevance; however, the predominant interests of members at such sites are Earth Energies and spirit presences.

Probably the most memorable site visit was to Tutbury Castle, in Staffordshire. Earth Energies and below-ground structures were dowsed but the highlight was undoubtedly a group ghost hunt. The sensitives in our company were visibly stirred if not shaken: a quite unique experience enjoyed on a glorious summer's day.

John Wright, Chairman, E.M.D.G.

Water Divining Group Report

On 22 November 2003 the Water Divining Special Interest Group held its Annual General Meeting at Ryton Gardens.



Jonathon Bennett was elected Communications Officer and agreed to write this short report from the BSD magazine. It will highlight the salient points from the meeting and not the formal business. Anyone wishing to see the minutes can apply to Jo Cartmale, the Secretary of the group.

The crux of the meeting was discussion about the aims and objectives of the group and defining a system of water dowsing that would give the most successful and

beneficial results. For those readers who are not familiar with the aims and objectives, here they are:-

AIMS • To provide a platform for exchange of ideas between water diviners at all levels of experience. • To develop the divining skills and knowledge of those members of the Society interested in the craft of water divining. • To convene as the Steering Group for the Village Water Appeal annually or as needed.

OBJECTIVES • To organise and hold meetings on water divining. • To invite experienced and skilled people to talk to members of the group. • To find suitable locations for the practice of water divining methods. • To develop training methods in water divining and liaise with the core curriculum of the BSD. • To develop methods of calibrating dowsers in relation to depth, volume, flow and water contaminants. • To organise courses for training at different levels in water divining. • When appropriate to organise research projects to expand the knowledge of water divining.

The group agreed to meet as the Village Water Steering Group. Village Water now has considerable funding enabling it to do some very useful work in the field of water dowsing. To this end the Steering Group has been asked to look at the proposals with regard to an initial programme in Zambia seeking water in remote villages. It is hoped this will come to fruition so that we can use the abilities of the Group supported by the funds currently being held by Village Water, to actually make some significant practical difference

to these remote villages in Zambia.

The Water Divining SIG was asked to consider if it wanted to join with archaeological dowsers and become a part of a Site Dowsing SIG, or other such name. The answer was a unanimous "no" as our purpose was very definitely water.

There was much discussion about honing our skills and being able to 'know' the results of our dowsing and having them confirmed. A programme of site visits for 2004 was agreed at which we hope to be able to improve our skills. This is one of the challenging aspects of dowsing that we all face.

How do we know if we are right? Well, for those who decide to go to Zambia, their skills will certainly be tested, hopefully successfully.

Peter Golding offered to let us know when a bore hole that he recently dowsed was to be drilled. Anyone interested could attend the drilling on site and see his efforts confirmed. A similar offer was made to the group by Peter Taylor who suggested we may like to visit a site where clay is present so that we can experience the problem of determining the correct depth under clay. Again we could witness the actual drilling.

The overall conclusion of the meeting was very positive indeed and the general feeling was that we should try to develop our water dowsing skills so that we use them in a practical and helpful way. The meeting was concluded with some dowsing in the gardens which proved interesting as, once again, put six dowsers in one place and one often gets six different results, this is an aspect we need to improve if we are to succeed in looking for water seriously.

For the record the meeting elected the following officers and dates for events during 2004:

| | |
|----------------------------|------------------|
| Chairman | Rowan Thompson |
| Vice Chairman | Peter Golding |
| Secretary & Treasurer | Jo Cartmale |
| Venue Organiser | Geoff Crockford |
| Communications Secretary | Jonathon Bennett |
| BSD Council Representative | David Dixon |

Members agreed a programme for year 2004, as follows:

April 24 (plus optional April 25): visit to Sussex led by Sylvia Bennett to dowsing land for a new water garden and other sites of interest.

June 26-27: two-day water divining visit to a number of willing farms in North Yorkshire, coordinated by Eleanor Burke.

Jonathan Bennett

Surrey Dowsers

PROGRAMME April to September 2004

Saturday 17th April - Earth Acupuncture
Speaker: Richard Creightmore, MA, BAc., FSSA

Saturday 15th May - Practical Dowsing Workshop
Leaders: Joan Meech, Tina Stone and Sue Wallace

Saturday 19th June - Village Water for Africa and Central America

Speaker: David J Dixon, Chartered Engineer

Saturday 18th September - Coach Trip to Ancient Sites in and around Canterbury

Organisers: Ann Stevenson and Bridget Hopkins

Greater Manchester Dowsers

A group of like minded people with a common interest in dowsing. Very informal meetings open to all.
Venue: Mosses Community Centre 7.30pm on the third

Friday of most months.

For Information Contact: Gillian Collins (Sec) on 01204883482



Correspondence

Letters to the Editor

Dear Editor,

In the December edition of Dowsing Today, Geoff Stuttaford wrote of his experiences with Tibetan Bowls. He asked if there is a Tibetan Society of Dowsers. There is certainly a tradition of Tibetan Geomancy, and there was a weekend of tuition by a lama at the Sam ye Ling Tibetan Monastery in Eskdalemuir, Scotland about eight years ago.

Several years ago, I experienced playing old, large Tibetan bowls in a workshop in Ireland. The old bowls were nearly a centimetre thick and made of five metals. My feeling was that their resonance would be very healing for

buildings as well as people.

Stephanie Bolton

Dear Editor,

Could you please let me know if there any articles or books on the role of dowsers, healers or mediums during World Wars 1 & 2 and on re-incarnated soldiers ?

Are there some amongst your members who specialise in this ?

*Jacques Ragot, 8 Rue Du Commandant De Courson,
F90300 Valdoie, France*



From the Office

Introduction

The Society's Office opened for business from its new premises near the centre of Great Malvern on 5th January. The Society also has a new Administrative Staff Team; Ian Clements took up his post as full-time Administrator on 1st October 2003 and was joined on 5th January by Helen Lamb (Admin Assistant) who works 20 hours/week and Jenny Davies (Finance Assistant) who works one day/week.

As well as providing an excellent Office Base from which to administer the organisation, the new premises provide the opportunity, for the first time, to display to both Members and the public, the full range of books and dowsing products that the Society has for sale. Added to this, the building provides a good venue for small, group meetings of up to 15 people; already three meetings have been held there and another group has booked for later in the year. Please let the Office know if you would like to make a booking for a meeting of any of the Society's Groups.

Looking further ahead, there is space here to create a

first class Reference Library and Archive and the opportunity to create and exhibit Displays on Dowsing and the work of the BSD.

The move to Malvern has created a lot of local interest which has already led to three articles in the local press and a request by BBC Midlands TV to record a feature in April.

Although we are not yet open to the public, we would welcome any Member of the Society who wishes to visit and browse through the extensive range of books and dowsing products for sale. Malvern is an interesting area with a strong, distinctive atmosphere and the Hills are beautiful and provide excellent walking. There are also Holy Wells to explore (St Ann's Well is only a short distance from the Office), a good Theatre and a wide range of accommodation.

A fuller feature on the Malvern Office, with photographs, will appear in the next Issue of Dowsing Today; meanwhile, if you would like to pay a visit, please phone first to check that there will be someone in.

Ian, Helen and Jenny

AGM Report

The 2004 AGM was held for the first time at the Friends House in London on 28th January. The twenty eight members who braved the snow and ice, approved the Minutes of the 2003 AGM, the Annual Report of Council and the Accounts for 2002/03. They also elected Wright Vigar as the Society's Accountants, Anne Leonard as a Vice-President and Sara Patraiko and John Irwin as members of Council; Guy Hudson was re-elected as a member of Council.

The Meeting then heard the President, Patrick MacManaway, explain that to bring greater equality of opportunity for all members, Council was seeking to reduce the length of time required for nominations for membership of Council to be submitted prior to the AGM. To achieve this, a proposal to amend Article 44 of the Articles of Association was put to the Meeting as an item of Special Business and was approved unanimously. As a result Article 44 now reads:-

'44. At each Annual General Meeting the Society shall elect a Vice-President and a minimum of three Councillors. Six weeks previous to the Annual General

Meeting, a list will be sent to every member resident in Great Britain containing the names of those retiring from the Council, together with any proposals for filling the vacancies on the Council. Names of Candidates for election to the Council proposed and seconded by members must be submitted to the Society by 23rd October in any year for election at the following Annual General Meeting.'

At the end of the Meeting, the Roy Talbot Award, for outstanding contributions to the fields of water and site dowsing, was presented to Clive Thompson and the Bell Award, for the most interesting and original contributions to the Society's Journal, was presented to Ian Pegler.

Presentations of quaiches were then made to Philip Garcin and David Mizen who were retiring from Council at the Meeting after many years of outstanding service to the Society.

The Meeting was followed by a most interesting lecture on the 'Essentials of Water Divining' by Clive Thompson.

Full minutes of the AGM will appear in a later issue of Dowsing Today, prior to the next AGM.

Council News

Council met on 28th January at Friends House, its new venue opposite Euston Station in London.

Richard West and Grahame Gardner were both unanimously co-opted on to Council. It was also agreed that, as part of the move to bring about a greater integration of the different elements of the Society, the Chairmen of each Special Interest Group and the Dowsing Research Group would be invited to join Council; as a first step, it was agreed to invite them to attend the April Meeting as observers. It was also agreed to invite Ian Pegler to join the Editorial Team of Dowsing Today.

Ian Clements gave his first Administrator's Report in which he described the final stages of the handover from Michael and Deidre Rust, the office move to Malvern before Christmas and the appointment of new staff. The transition had, for the most part, been smooth for which great credit was due to Michael and Deidre.

At the meeting, Council received and approved a series of reports from its Sub-Committees and Working Parties.

The Finance Sub-Committee presented an up to date Cash Flow Forecast, a Statement of Financial Reserves and a Statement of Financial Performance during the first half of the financial year. Council approved the Sub-Committee's recommendation to appoint Tony Petheram, a qualified Accountant, as the Society's Consultant Financial Adviser with a particular brief to oversee Investment Strategy.

The Special Interest Group Working Party had focused

its attention on how the SIGs and the rest of the Society could work together more effectively. Congress Sub-Committee had chosen 'Breaking New Ground' as the theme for this year's event which would be held at Cirencester on 10th-12th September. The format would be based on a series of Lectures and Workshops which, for the most part, would be planned and organised by the Special Interest Groups and the Dowsing Research Group; the Sub-Committee proposed that the 2005 Congress should be held in Malvern and this was approved.

The Education Sub-Committee had concentrated on resolving some teething problems with the Tutors' Register and planning courses and lectures for the rest of 2004 and 2005, and Council approved the Village Water Steering Group's proposals to spend £16,300 from the Village Water Fund on a on a matched funding, joint venture Project with Harvest Help (a British Charity with experience of working in Africa) in Zambia.

Reports were also received from each of the Special Interest Groups and the Dowsing Research Group, and from a small Working Group that was looking at re-designing the Society's website.

Twenty eight new members of the Society were elected and the meeting closed with formal votes of thanks from Council to Michael and Deidre Rust and to Philip Garcin and David Mizen, the two Council members who would be retiring at the AGM later that day. All had given enormous and valuable service to the Society for which Council were deeply grateful.

Notices

Giving to the BSD through your Tax Return

From April 2004, people who complete a Self-Assessment Tax Return will be able to nominate a charity to receive all or part of any repayment due to them. The inland Revenue repaid around £3 billion to nearly 3 million Self-Assessment taxpayers last year.

If you complete a Self-Assessment Tax Return and you wish to give all or part of any tax repayment that is due to you to the British Society of Dowsers, you will need to enter on your Tax Return a code that is unique to the Society. This code is **UAM74BG**. Any donation will be paid directly to the Society's Bank Account to be used to support all aspects of its work.

Please note that this new scheme does not replace the existing Gift Aid scheme.

Giving to 'Village Water' and 'Water for Life'

The Society also welcomes donations to both the **Village Water** and **Water for Life** funds.

Village Water is the Society's own Project which is planning a major match funding, joint-venture this year with

Harvest Help (a British Charity with experience of working in Africa) to find and secure water supplies in Zambia. By combining forces with Harvest Help, over £32,000 will be available to fund this work.

Water for Life supports 'Reaching the Unreached' and the work of Brother Kimpton for the very poorest people in Southern India. From donations that it has received, the Society has recently been able to donate a further £2,500 which will be used to start drilling for water again following an 18 month long drought.

Both funds rely entirely on donations and fundraising. If you would like to give to either, please send your payment to the Society's Office in Malvern made payable to either 'Village Water' or 'Water for Life'.

Notice

Just as this issue of the Journal was being finalised, we learned of two sad losses to the field of dowsing. Firstly that Jack Temple, the renowned author and dowser, had died on the 13th February. Secondly that Dr Kenneth Leslie Howe had died on 5th February 2004. Dr Howe had been an active member of the Society for 40 years and had spoken at both National and International Congresses.

It is hoped to be able to report more fully on the lives of both in the next issue of the Journal.

Notices

The British Society of Dowzers
Course



DOWSING FOR BEGINNERS
at The Royal Agricultural College,
 Cirencester, Glos
 2 – 4 April

Tutor: Patrick MacManaway

You will be given the opportunity to learn basic dowsing skills and techniques and shown various aspects in which they can be used.

Cost: £153 non-residential, £171 for standard room, £187.50 en suite room.

There is a surcharge of £5/person for non-members of the BSD. Application forms from the BSD Office

The British Society of Dowzers
Course



ARCHAEOLOGY COURSE
at The Royal Agricultural College,
 Cirencester, Glos
 25 –27 June

Tutor: Alan Neal

This course will cover various aspects of archaeological dowsing, including finding the depth and age of foundations, positions of sleeping, cooking and storage areas, map dowsing backed up with as much field work as possible.

Cost: £153 non-residential, £171 for standard room, £187.50 en suite room.

There is a surcharge of £5/person for non-members of the BSD. Application forms from the BSD Office.

The British Society of Dowzers
Course



DOWSING FOR HEALTH
at Winford Manor, Winford,
 Bristol, N Somerset
 16-18 July

Tutor: Mary Ison

This course is for those who have attended a beginner's course or who know how to dowse and wish to apply their dowsing to the healing arts.

Based on the BSD Dowsing Curriculum, this course offers an introduction to using dowsing to promote good health and healing both in ourselves and for the benefit of others.

Cost: £150 non-residential, £175 residential.
There is a surcharge of £5/person for non-members of the BSD. Application forms from the BSD Office.

Dowsing Research Group

The DRG holds about five one day meetings and one weekend meeting for its members during the year. Details of the meetings and applications for membership are available from the secretary
Mrs J Cartmale,
email: jo.cartmale@talk21.com~
tel: 01604 646472.

The dates of meetings for 2004 are:

| | |
|-------------|---------------------------------|
| 14 February | The Society Office at Malvem |
| 20 March | Lockeridge, Wilts |
| 8 May | Ryton Organic Gardens, Coventry |
| 12-13 June | Nash Hotel, West Sussex |
| 16 October | Ryton Organic Gardens, Coventry |
| 13 November | Churchill College, Cambridge |

Venues and dates may be changed.

Water Divining Special Interest Group

Programme of meetings for 2004

The water Divining SIG is holding three main meetings in 2004. They are:

Saturday 24 April - Haywards Health W Sussex
The weekend 26-27 June - North Yorkshire
Saturday 2nd October - AGM, Malvem

Apart from the AGM the meetings focus on practical water divining at selected locations. In addition to the three main meetings there are informal meetings arranged at short notice by members when something of interest crops up. Members of the SIG are notified of these meetings as they arise.

The Water Divining SIG is open to all members of the Society. Application for membership (cost £10) should be made to Mrs Jo Cartmale, address on back cover.



Earth Energies Special Interest Group

FORTHCOMING EVENTS

Spring Meeting: Frilford, Oxfordshire on March 27th and 28th. Speakers: Jim Lyons, Bob Sephton and Peter Taylor.

Summer weekend: Provisionally July 17th and 18th (Ancient sites and crop circles).

Autumn meeting: Glastonbury, October 9th and 19th. Speakers to be announced.

Training day by Billy Gawn: Date to be announced.

Please contact Jo Cartmale for information on 01604 646472

Notices

1. DATES FOR YOUR DIARY

PLEASE NOTE - 2004 London Lectures will be held at Friends House, 173 Euston Road, London NW1 2BJ.

Admission fees – members £5, non-members £6, which include refreshments. Doors are open at 6pm and the Lectures commence at 6.45pm.

Tuesday 20 April - London Lecture: Designing Sacred Temples and Stone Circles by Ivan McBeth. Ivan will give a slideshow presentation on his subject and will focus on the invisible aspects of creating sacred space and different phenomena with which these artefacts are aligned.

3 - 6 June - International Seminar on Earth's Fields and their Influence on Organisms: Lithuania. Organised by the Baltic Dowisers.

Thursday 15 July - London Lecture: the lecturer will be announced in the next issue of Dowsing Today.

2. ITEMS AVAILABLE FROM THE BSD OFFICE:-

| | |
|---|-------------|
| Crystal pendulum on silver chain, 18mm, 2.5gms | £4.65 each |
| Crystal pendulum on silver chain, 40mm, 6.0gms | £6.10 each |
| Crystal pendulum on silver chain, 36mm 10gms | £6.80 each |
| Nickel plated brass pendulum 25gms | £12.30 each |
| Hollow clear perspex pendulum 40mm | £12.00 each |
| Solid clear perspex pendulum 30mm | £5.75 each |
| Wooden pendulum plain waxed 25mm diam turnip shaped | £5.25 each |
| Wooden pendulum plain waxed 25mm diam carrot shaped | £5.25 each |
| Wooden pendulum 30mm diam, handcrafted and polished | £10.60 each |
| Hawthorn pendulum 20mm diam | £7.75 each |
| Brass bullet shaped pendulum 35mm 18gms | £9.15 each |
| Nickel plated bullet shaped pendulum 35mm 18gms | £10.35 each |
| 8" nylon V rod | £2.05 each |
| 16" nylon V rod | £4.30 each |
| Angle rods 6" long – Stainless steel | £4.30 pair |
| Angle rods 16" long – Stainless steel | £4.70 pair |
| Brass | £5.50 pair |
| Copper | £8.50 pair |
| Dowsing wands – single flexible rod 18" or 24" long | £4.85 each |

Mager Rosette – coloured disc – colours on both sides £3.50 each
Available to members only –

BSD Tie – gold motif on blue or brown £7.90 each

Car badge window sticker £2.15 each

Remittance with order, please. All are post free to the UK. Overseas orders will be sent by airmail, please add 20% of order to cover this cost. Payment in Sterling only or you may order through telesales and pay by Visa Card.

3. FRONT COVER OF JOURNAL

With the new format of the Society's Journal, we are trying to build up a collection of slides or photographs related to dowsing which the editors may use as necessary for the front cover. If any members feel they do have some which may be of use please contact us. The Society is willing to cover the cost of copying slides, photographs etc so that the originals may be retained. We would like to thank those who have taken the trouble to send items to us.

4. JOURNAL BINDERS

With the change in the format of the Society's Journal to A4 size, we are pleased to offer binders each holding 12 copies. They are of excellent quality and produced in dark green with the words 'Journal of The British Society of Dowisers' and the Society's logo on the spine in gold. The price for each binder is £5.50 which includes post and packing. Please send your cheque to the office with your order.

5. BOOKS IN THE BSD BOOKSHOP

Messages From Water, Vol 1 by Masaru Emoto £18.90 + £2.84 p&p. Shows how the molecular structure of water is affected by human and environmental surroundings.

Messages From Water, Vol 2 by Masaru Emoto £18.90 + £2.84 p&p. Another volume with further effects on water. Both books are fascinating.

Hidden Nature by Alick Bartholomew £20.00 Pb + £3 p&p. The startling insights of Victor Schauberger. His amazing discoveries - addressing issues such as sick water, ailing forests, climate change and, above all, renewable energy.

The postage and packing quoted is for the UK only. Overseas post please add 20% of the value of the books for surface mail postage. If you require airmail posting please contact the office for a quote.

Advertisements

Dowsing for Beginners

A 2-day British Society of Dowisers Approved Course

Prestberries Natural Therapy Centre, Blackwells End, Hartpury, Glos.

Discover how dowsing can be applied to everyday life. Prestberries, a delightful old farmhouse dating from the 15th century, provides ideal opportunities for learning to dowse.

10am-4pm, Saturday 24th April and Saturday 22 May

Cost: £45 per day, to include refreshments and 2-course hot lunch.

For more information: telephone John Moss: 01989 750114
To book: telephone Prestberries on 01452 700306

Accessing your Intuition via Dowsing

With Roy & Ann Procter

Workshops:

(Accredited by National Open College Network)

**Next dates: Friday 16 April
and Saturday 3 July 2004**

"Coombe Quarry", Keinton Mandeville, Nr Somerton,
Somerset TA11 6DQ

Tel. 01458 223215 Fax.01458 224234

For details see:

<http://dSPACE.dial.pipex.com/procter>

Advertisements

Dowsing for Health

with Patrick MacManaway
Leading Dowser & President of the BSD

ON: Saturday 17th & Sunday 18th July 2004 9.30am - 4.30pm each day

AT: Nash Hotel, Horsham Road, Steyning 01903 814988
www.nashmanor.co.uk

This is an ideal opportunity to spend a weekend with this very knowledgeable person.

Patrick will provide a very inspiring day on:

- ❖ Health related Dowsing
- ❖ Sacred Space
- ❖ Geopathic Stress
- ❖ Geomancy

Nash has a Stone Circle, Vesica Piscis & Labyrinth
If you are interested please call us for further information.

Phone: 01903 814988 for more details and to book.
Please book early to avoid disappointment.
COST: £40 per day including lunch & refreshments each day.
Bed & Breakfast is available at Nash.

Dr Patrick MacManaway is a dowser and holistic therapist. He trained first in dowsing and healing therapies with his parents, holistic pioneers Bruce and Patricia MacManaway. He pursued his personal interest in holistic environmental studies by taking a two year apprenticeship in Western geomancy and studying Feng Shui. He teaches and lectures widely on dowsing, healing and geomancy.

THE FENG SHUI SOCIETY (London Group)

TALKS AND EVENTS

On the first Wednesday evening of each month from 7.30 to 9.30pm The Feng Shui Society holds very interesting talks at Rudolph Steiner House, 35 Park Road, London NW1 6XT. You are cordially invited to join us. The fee for non-members is £5 and members of the FSS is £3 (pay on the day). Contact Sylvia Bennett 020 7916 9880.

- 7th April-Universal Principles of Sacred Geometry by Jude Currivan
- 5th May-From China to Chelsea- by expert garden designer Maureen Busby
- 2nd June-5 Elements and Our Health-by Alan Treharne

One day workshop – Sunday 21 March – 10.30 to 4.30 – The art of Vastu Shastra – Raymond Catchpole (Non-members £35 – members £30 (Contact Aroon 020 8455 1158 e-mail: aajmera999@aol.com)

The Feng Shui Society has a unique role of being the only independent, non-profit, Feng Shui Organisation in the UK maintaining professional standards to promote ethical practice of Feng Shui and serving as a focus for exchange of information for the Feng Shui community and others wishing to develop their knowledge and apply the principles in their own lives.

Further details of membership, regular events, courses and related activities are obtainable from The Feng Shui Society at 07050 289 200 or on www.fengshuisociety.org.uk